

Component Locations			
Description	Part Number	Machine Location	Schematic Location
Accumulator Gp - Pilot Manifold	164-6981	1	B-4
Cylinder Gp - Boom	Note A	2	F-5
Cylinder Gp - Bucket	Note A	3	E-5
Cylinder Gp - Stick	Note A	4	F-5
Filter Gp - Case Drain	126-2975	5	A-4
Filter Gp - Pilot Hydraulic	158-8987	6	A-4
Filter Gp - Return Oil	188-140	7	B-6
Motor Gp - Hydraulic Fan	234-4639	8	C-6
Motor Gp - Left Travel	271-6376	9	F-3
Motor Gp - Right Travel	271-6376	10	F-2
Motor Gp - Swing	200-3373	11	F-7
Pump Gp - Hydraulic Fan	259-0815	12	B-3
Pump Gp - Main and Pilot	283-6116	13	A-2
Sensor As - Left Pump Press.	221-8859	14	A-2
Sensor As - Right Pump Press.	221-8859	15	B-2
Switch As - Left Travel Pilot	167-3466	16	D-7
Switch As - Pilot Pressure	167-3466	17	A-7
Switch As - Right Travel Pilot	167-3466	18	D-6
Swivel Gp	234-4440	19	E-3
Tank As - Hydraulic Oil	239-1661	20	A-5
Valve Gp - Check, Cooler Bypass	190-7745	21	C-7
Valve Gp - Control, Auxiliary	259-7378	22	D-5
Valve Gp - ECV, Check Solenoid	297-0370	23	F-4
Valve Gp - ECV1, Check Solenoid	297-0370	24	E-4
Valve Gp - ERV1, Sol. and Relief	244-4506	25	E-4
Valve Gp - Heavy Lift Solenoid	121-6303	26	B-4
Valve Gp - Left Travel Counterbalance	204-2819	29	E-3
Valve Gp - Load Control Boom Cylinder	255-5683	30	D-1
Valve Gp - Load Control Stick Cylinder	255-5680	31	D-4
Valve Gp - Main Control	285-1345	32	C-1 to C-6
Valve Gp - Neg. Flow Control	171-0188	33	E-1
Valve Gp - Pilot Manifold	215-5037	34	B-5
Valve Gp - Pilot, Bucket and Boom	270-6952	35	B-6
Valve Gp - Pilot, Stick and Swing	270-5951	36	B-7
Valve Gp - Press. Red. Boom/ Swing	232-4102	37	B-4
Valve Gp - Press. Red. Bucket/ Stick	232-4102	38	A-5
Valve Gp - Pressure Relief	206-3354	39	A-5
Valve Gp - Right Travel Counterbalance	204-2819	40	E-2
Valve Gp - Shuttle	185-0462	41	A-6
Valve Gp - Shuttle	259-7732	42	B-4
Valve Gp - Swing Cushion	158-8090	43	E-7
Valve Gp - Travel Pilot	270-5947	44	D-6
Valve Gp - Work Tool, (4 Function)	259-7429	45	E-1
Attachments			
Pump Gp - Auxiliary, Medium Pressure	207-8235	50	B-2
Valve Gp - Control, Med. Press.	232-4103	51	F-6
Valve Gp - Solenoid and Press. Reducing	259-7430	52	E-2

Note A: Refer to service manual for specific cylinder information.

Tap Locations Pressure and Sampling		
Tap Number	Description	Schematic Location
AA	Left Pump Delivery Pressure	B-1
BB	Right Pump Delivery Pressure	B-1
CC	Pilot Pump Delivery Pressure	A-4
GG	Pilot Pressure Pb1 (B1), Attachment	F-1
HH	Pilot Pressure Pa1 (B2), Attachment	F-1
II	Pilot Pressure BR2 (B3), Attachment	F-1
JJ	Pilot Pressure aR2 (B4), Attachment	F-2
KK	Right Pump Pilot Pressure	E-1
LL	Left Pump Pilot Pressure	E-1
MM	Pilot Pressure MPb1 (B1), Attachment	E-2
NN	Pilot Pressure MPa1 (B2), Attachment	E-2
OO	Pump Power Shift Pressure	B-1
PP	Auxiliary Pump Pressure	F-7
SOS	Hydraulic Oil Sampling Port	A-4

Schematic

330D and 336D Excavator Hydraulic System - Attachment

330D:
GBC1-UP
GGE1-UP
THJ1-UP
PEL1-UP
LRM1-UP
ERN1-UP
RAS1-UP
T2Y1-UP

336D:
JBF1-UP
MYG1-UP
KDJ1-UP
PPN1-UP
MYP1-UP
DTS1-UP
WET1-UP

System 17: Combined Function with Medium Pressure

© 2010 Caterpillar. All Rights Reserved

Printed in U.S.A.

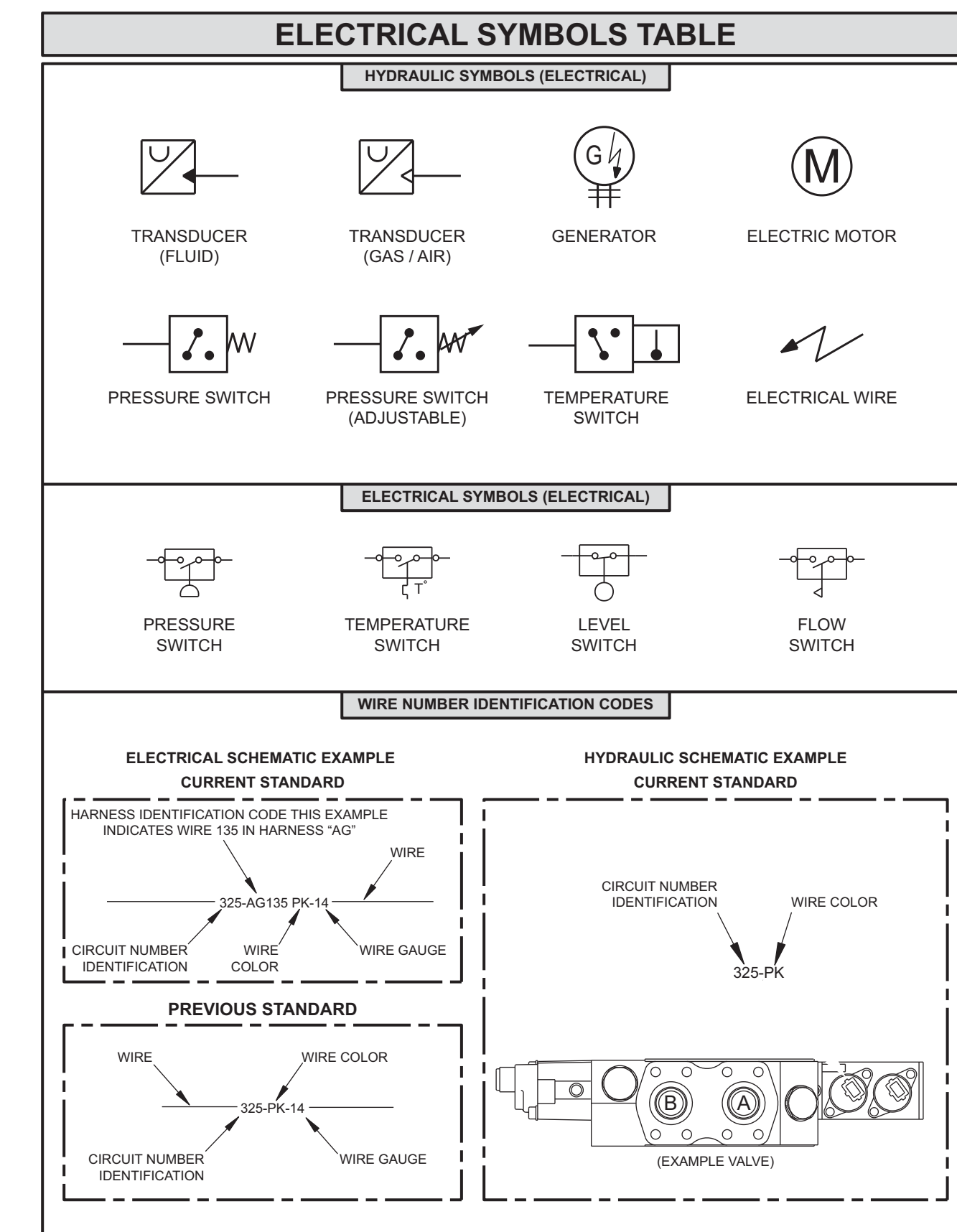
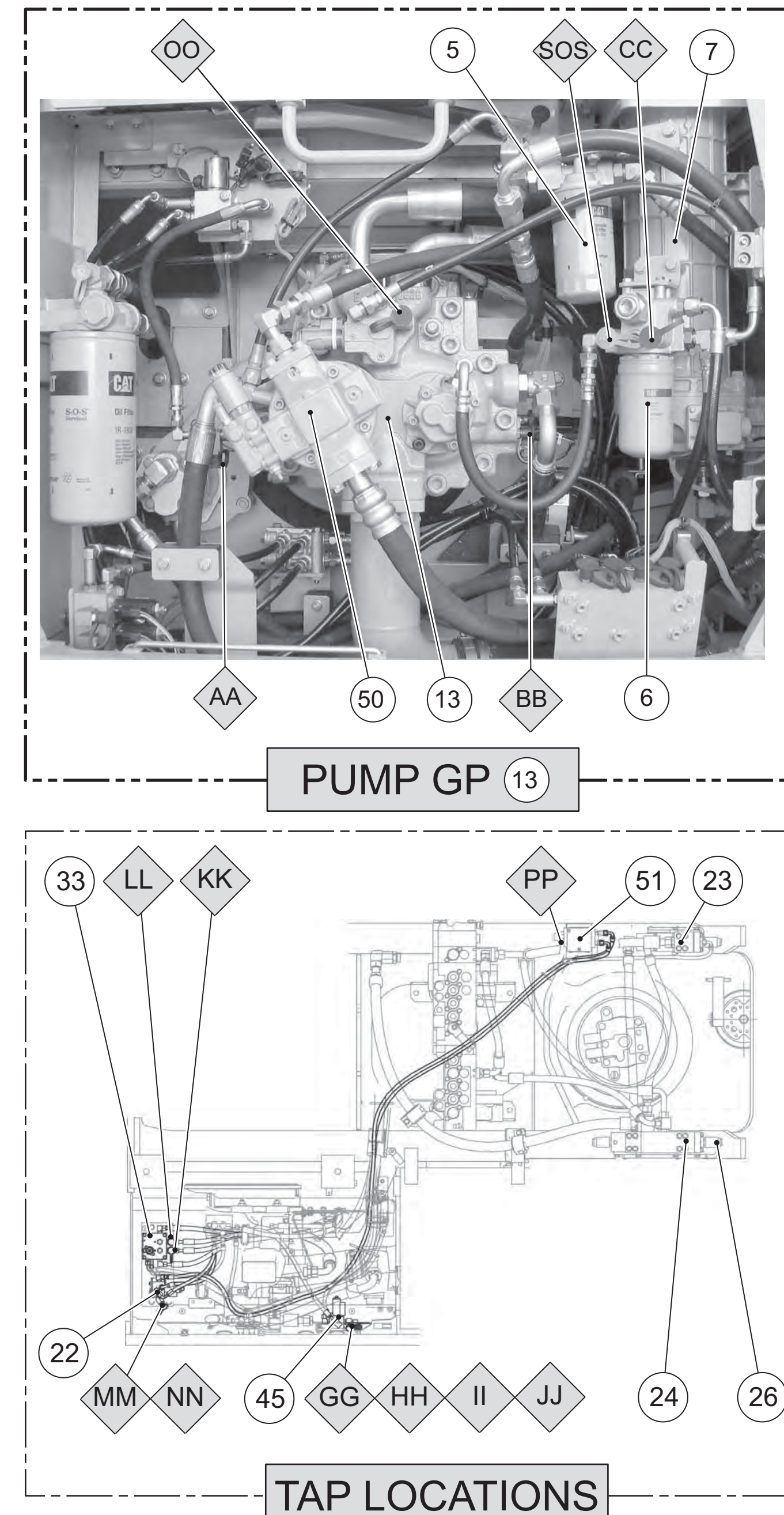
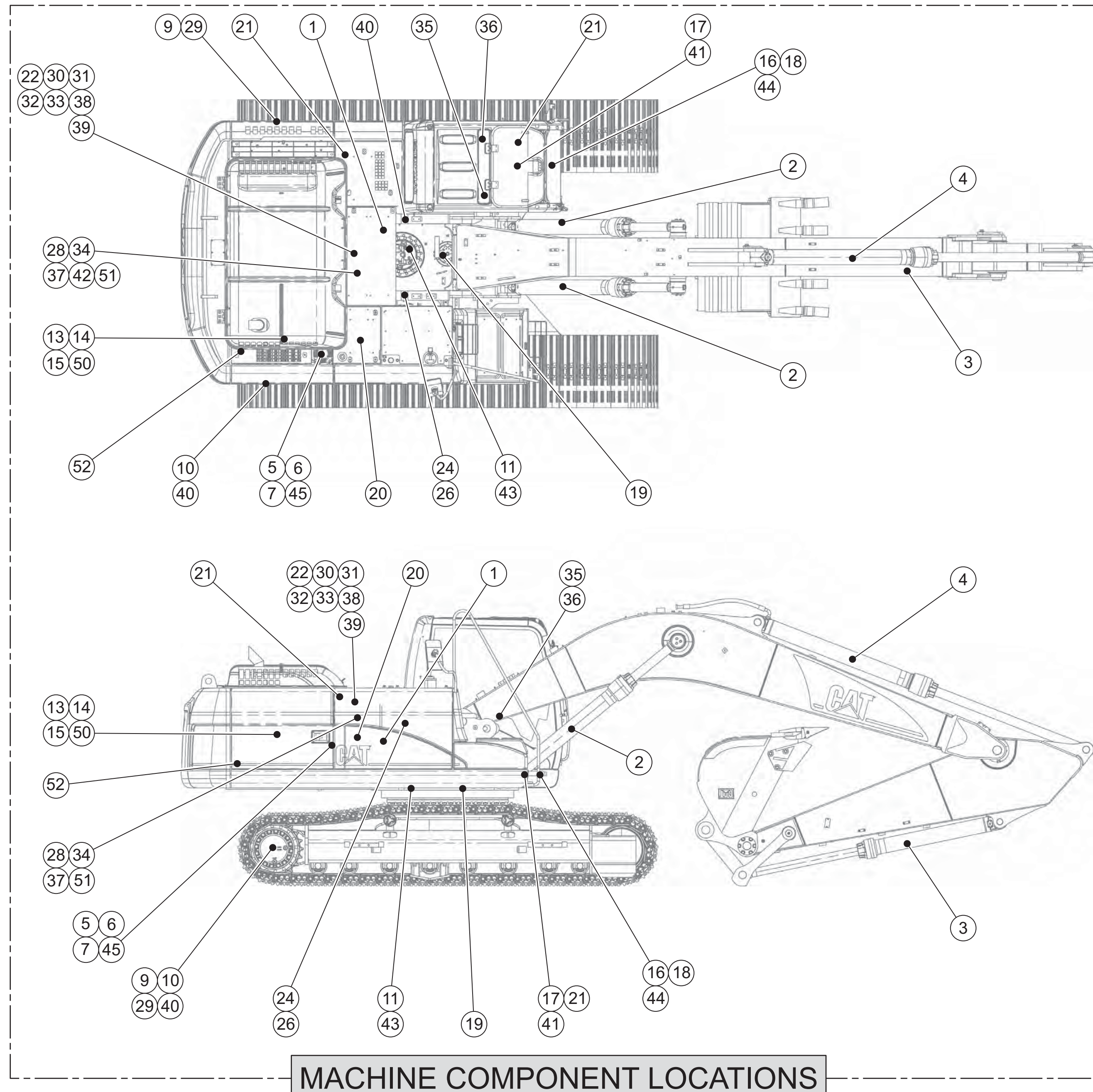
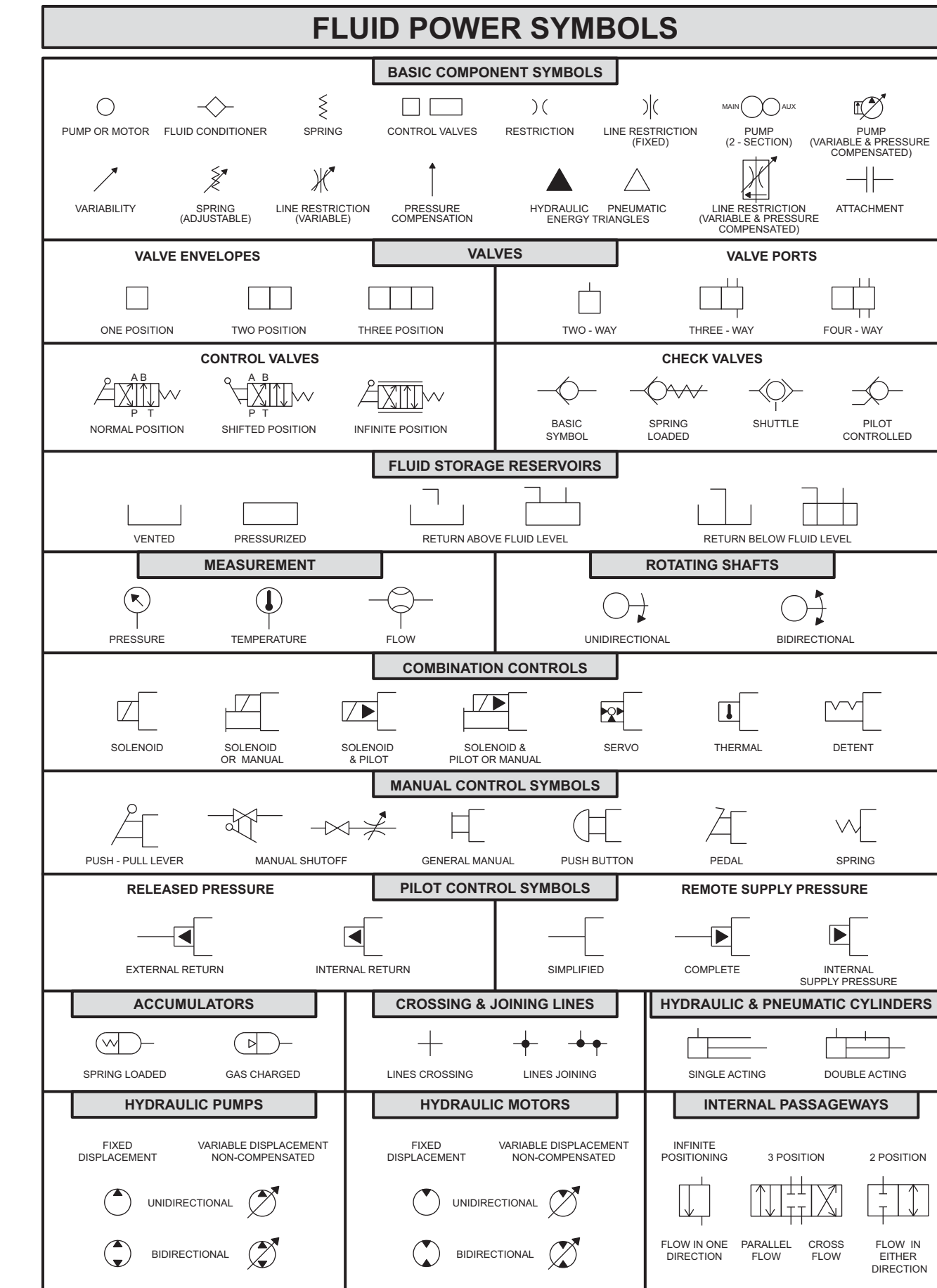

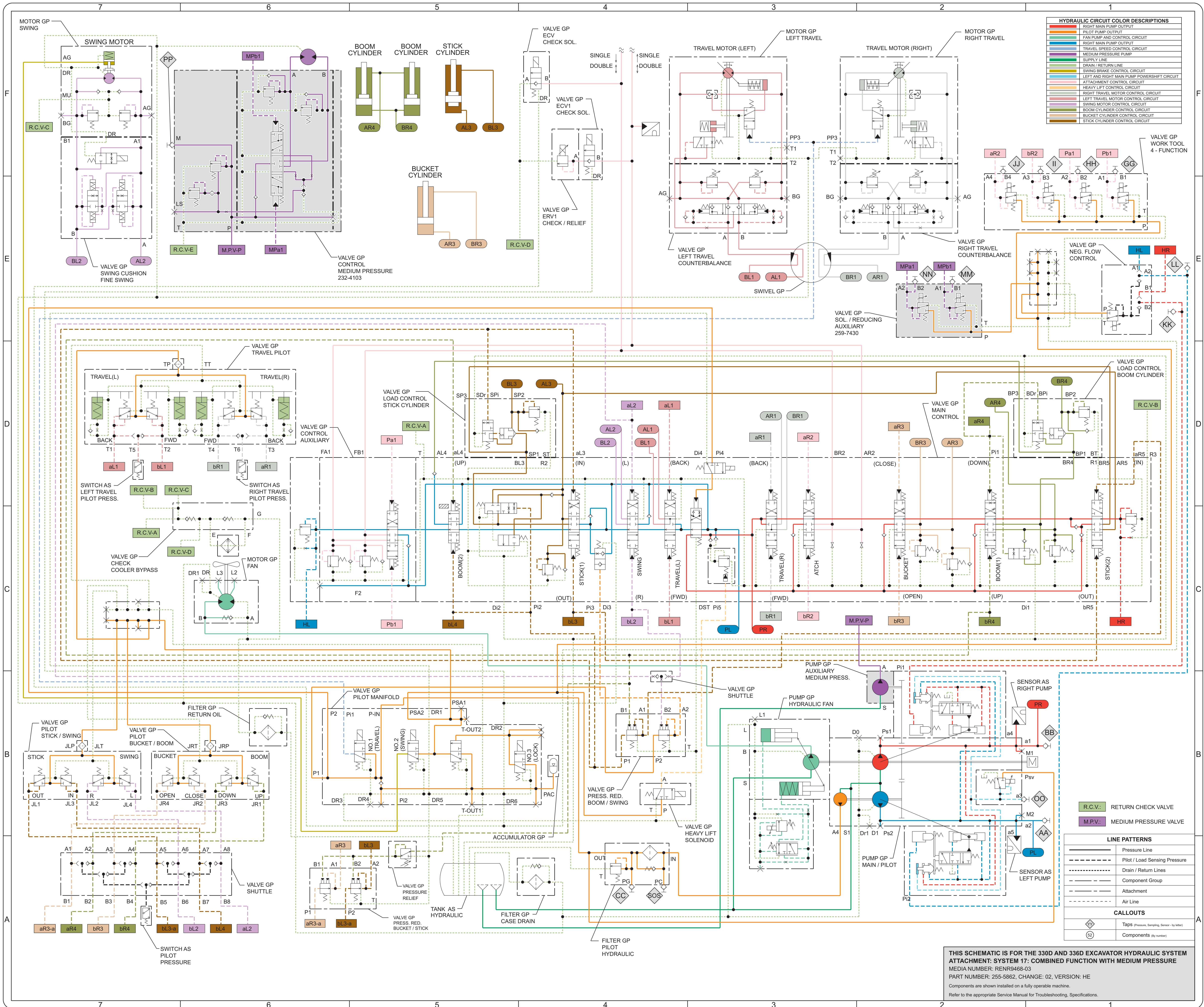

HYDRAULIC CIRCUIT COLOR DESCRIPTIONS

Red	RIGHT MAIN PUMP OUTPUT
Orange	RIGHT MAIN PUMP OUTPUT
Yellow	FAN PUMP AND CONTROL CIRCUIT
Green	RIGHT MAIN PUMP OUTPUT
Blue	TRAVEL SPEED CONTROL CIRCUIT
Purple	MEDIUM PRESSURE PUMP
Light Blue	SUPPLY LINE
Dark Blue	DRAIN / RETURN LINE
Light Green	SWING BRAKE CONTROL CIRCUIT
Light Purple	LEFT AND RIGHT MAIN PUMP POWERSHIFT CIRCUIT
Light Orange	ATTACHMENT CONTROL CIRCUIT
Light Yellow	HEAVY LIFT CONTROL CIRCUIT
Light Blue-Gray	RIGHT TRAVEL MOTOR CONTROL CIRCUIT
Light Green-Gray	LEFT TRAVEL MOTOR CONTROL CIRCUIT
Light Purple-Gray	SWING MOTOR CONTROL CIRCUIT
Light Orange-Gray	BUCKET CYLINDER CONTROL CIRCUIT
Light Yellow-Gray	STICK CYLINDER CONTROL CIRCUIT

LINE PATTERNS

—	Pressure Line
- - -	Pilot / Load Sensing Pressure
---	Drain / Return Lines
---	Component Group
---	Attachment
---	Air Line

CALLOUTS

⊕	Taps (Pressure, Sensing, Sensor - by letter)
⊙	Components (by number)

THIS SCHEMATIC IS FOR THE 330D AND 336D EXCAVATOR HYDRAULIC SYSTEM ATTACHMENT: SYSTEM 17: COMBINED FUNCTION WITH MEDIUM PRESSURE MEDIA NUMBER: REN9468-03 PART NUMBER: 255-5862, CHANGE: 02, VERSION: HE Components are shown installed on a fully operable machine. Refer to the appropriate Service Manual for Troubleshooting, Specifications.