

COMPONENT LOCATIONS			
Description	Part Number	Machine Location	Schematic Location
CYLINDER GP - VAR GAUGE UNDERCARRIAGE	233-8502	1	E-1, E-2, F-1, F-2
FILTER GP - CASE DRAIN	126-2075	2	A-4
FILTER GP - HYD (PILOT)	158-8987	3	A-4
FILTER GP - RETURN	188-4140	4	A-6
MANIFOLD GP - CONTROL	215-5037	5	B-5, B-6
MOTOR GP - FAN	191-5611	6	A-7
MOTOR GP - SWING	200-3373	7	E-7
MOTOR GP - TRAVEL	9Q-5697	8	E-4, E-5
PUMP GP - FAN	194-8384	9	B-3
PUMP GP - MAIN	250-2564	10	B-3
SCREEN GP	188-4067	11	A-4
SWIVEL GP	166-3088	12	E-5
VALVE GP - CHECK	190-7745	13	B-7
VALVE GP - CUSHION CROSSOVER RELIEF	158-9085	14	E-7
VALVE GP - FAN DRIVE PUMP RELIEF	200-3312	15	B-4
VALVE GP - MAIN CONTROL	258-0290	16	C-3 thru C-6
VALVE GP - PILOT	158-8250	17	D-8
VALVE GP - PILOT (LEFT UNIT)	216-6750	18	C-8
VALVE GP - PILOT (RIGHT UNIT)	216-6751	19	C-8
VALVE GP - PRESSURE REDUCING	232-4102	20	B-4
VALVE GP - SHUTTLE	185-0462	21	C-8
VALVE GP - TRACTION CONTROL	244-6346	22	E-4, E-5

Tap Locations Pressure, Sampling, and Sensor		
Tap Number	Description	Schematic Location
AA	PILOT FILTER PRESSURE TAP	A-5
BB	LEFT TRAVEL MOTOR (M) PRESSURE GAUGE	F-7
CC	LEFT TRAVEL MOTOR (M1) PRESSURE GAUGE	F-6
DD	RIGHT TRAVEL MOTOR (M1) PRESSURE GAUGE	F-6
EE	RIGHT TRAVEL MOTOR (M) PRESSURE GAUGE	F-5
FF	FAN RELIEF VALVE PRESSURE TAP	B-4
GG	DRIVE PUMP DELIVERY PRESSURE TAP	B-2
HH	IDLE PUMP DELIVERY PRESSURE TAP	A-2
JJ	POWER SHIFT PRESSURE TAP	A-2
SOS	PILOT FILTER SAMPLING TAP	A-5

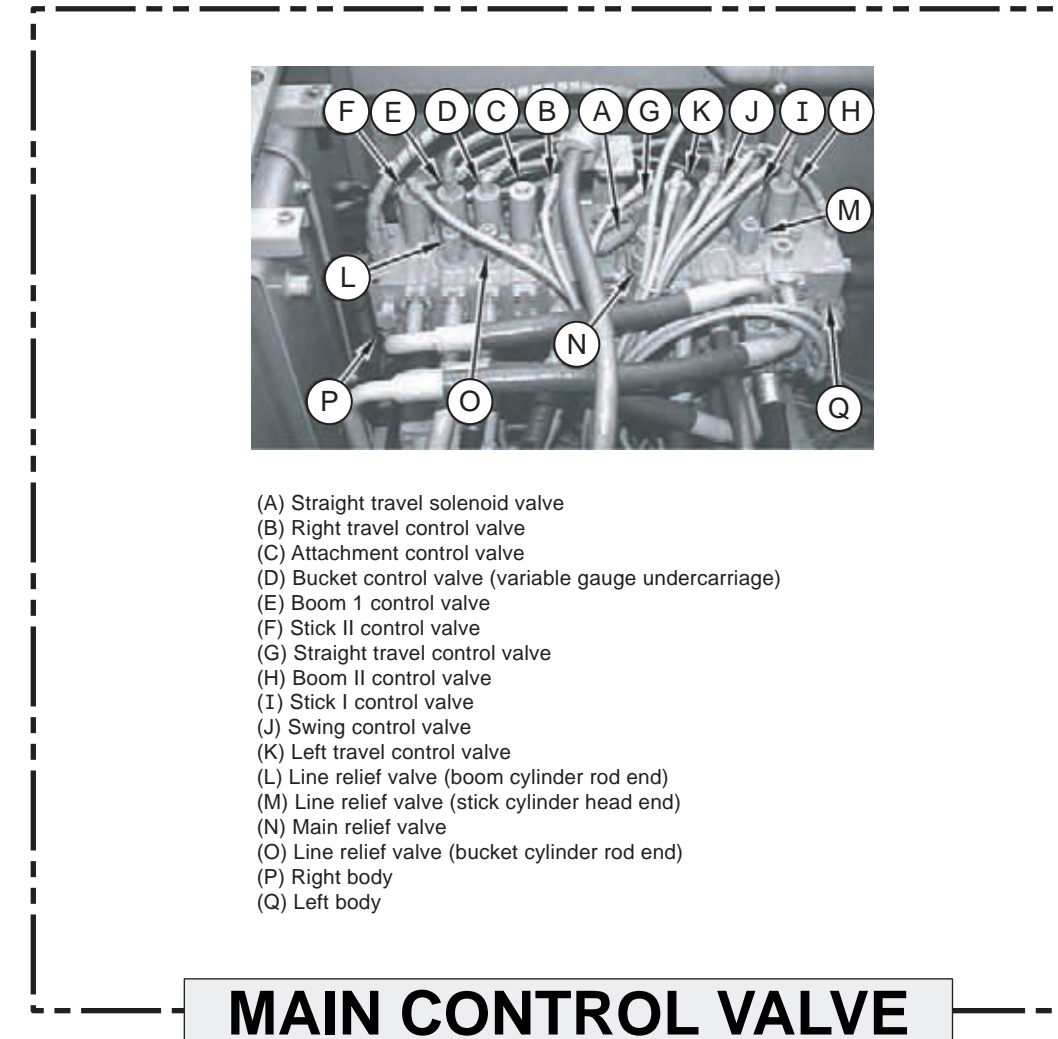

MAIN CONTROL VALVE

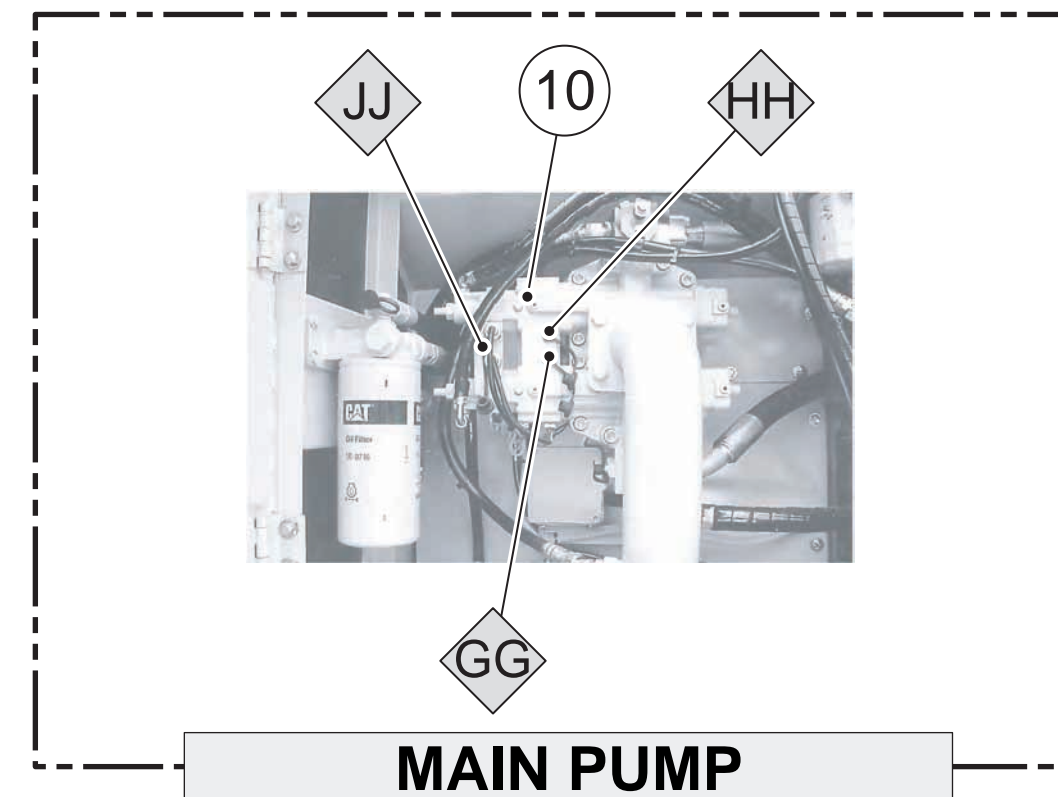

MAIN PUMP

CATERPILLAR®

KENR7846
June 2007

www.manuals-free.com

Schematic

330C MHPU Excavator
Hydraulic System

MSL1-UP

www.manuals-free.com

FLUID POWER SYMBOLS			
BASIC COMPONENT SYMBOLS			
PUMP OR MOTOR	FLUID CONDITIONER	SPRING	CONTROL VALVES
RESTRICTION	LINE RESTRICTION	PISTON	LINE RESTRICTION
2-SECTION PUMP	PUMP VARIABLE DISPLACEMENT	RESTRICTION	LINE RESTRICTION
VALVE ENVELOPES			
ONE POSITION	TWO POSITION	THREE POSITION	VALVE PORTS
TWO-WAY	THREE-WAY	FOUR-WAY	
CONTROL VALVES			
NORMAL POSITION	SHIFTED POSITION	INFINITE POSITION	CHECK VALVES
BASIC SYMBOL	SPRING LOADED	SHUTTLE	PILOT CONTROLLED
FLUID STORAGE RESERVOIRS			
VENTED	PRESSURIZED	RETURN ABOVE FLUID LEVEL	RETURN BELOW FLUID LEVEL
MEASUREMENT			
PRESSURE	TEMPERATURE	FLOW	ROTATING SHAFTS
UNDIRECTIONAL			UNDIRECTIONAL
COMBINATION CONTROLS			
SOLENOID	SOLENOID OR MANUAL	SOLENOID AND PILOT OR MANUAL	SERVO
DETENT			
MANUAL CONTROL SYMBOLS			
PUSH-PULL LEVER	MANUAL SHUTOFF	GENERAL MANUAL	PUSH BUTTON
PEDAL	SPRING		
PILOT CONTROL SYMBOLS			
RELEASED PRESSURE			REMOTE SUPPLY PRESSURE
EXTERNAL RETURN	INTERNAL RETURN	SIMPLIFIED	COMPLETE
INTERNAL SUPPLY PRESSURE			
ACCUMULATORS			
SPRING LOADED	GAS CHARGED		
CROSSING AND JOINING LINES			
LINES CROSSING	LINES JOINING	HYDRAULIC AND PNEUMATIC CYLINDERS	
		SINGLE ACTING	DOUBLE ACTING
HYDRAULIC PUMPS			
FIXED DISPLACEMENT	VARIABLE DISPLACEMENT NON-COMPENSATED	FIXED DISPLACEMENT	VARIABLE DISPLACEMENT NON-COMPENSATED
UNDIRECTIONAL		UNDIRECTIONAL	
BI-DIRECTIONAL		BI-DIRECTIONAL	
INTERNAL PASSAGEWAYS			
INFINITE POSITIONING	THREE POSITION	TWO POSITION	

©2007 Caterpillar
All Rights Reserved

Printed in U.S.A.

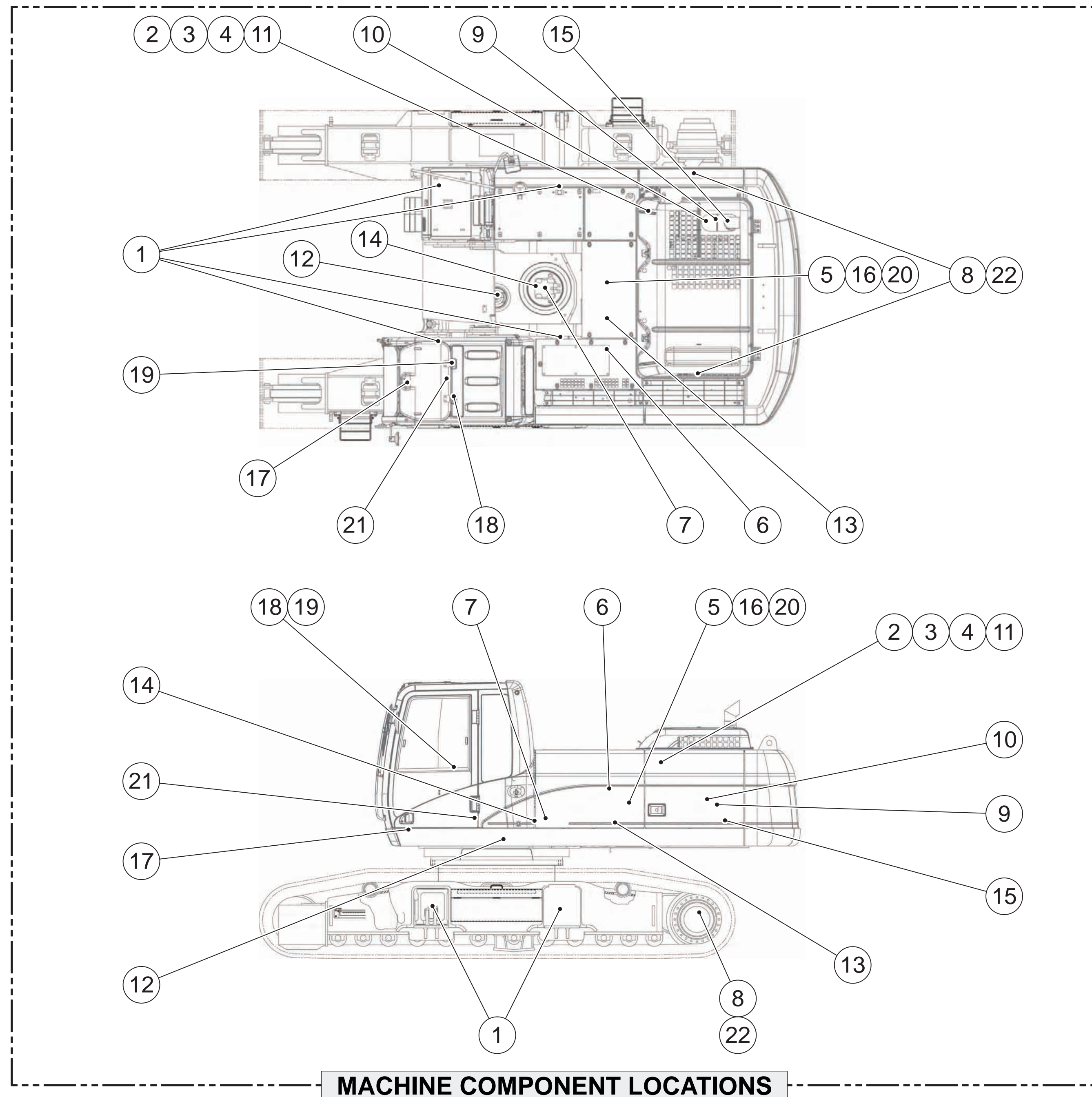

MACHINE COMPONENT LOCATIONS

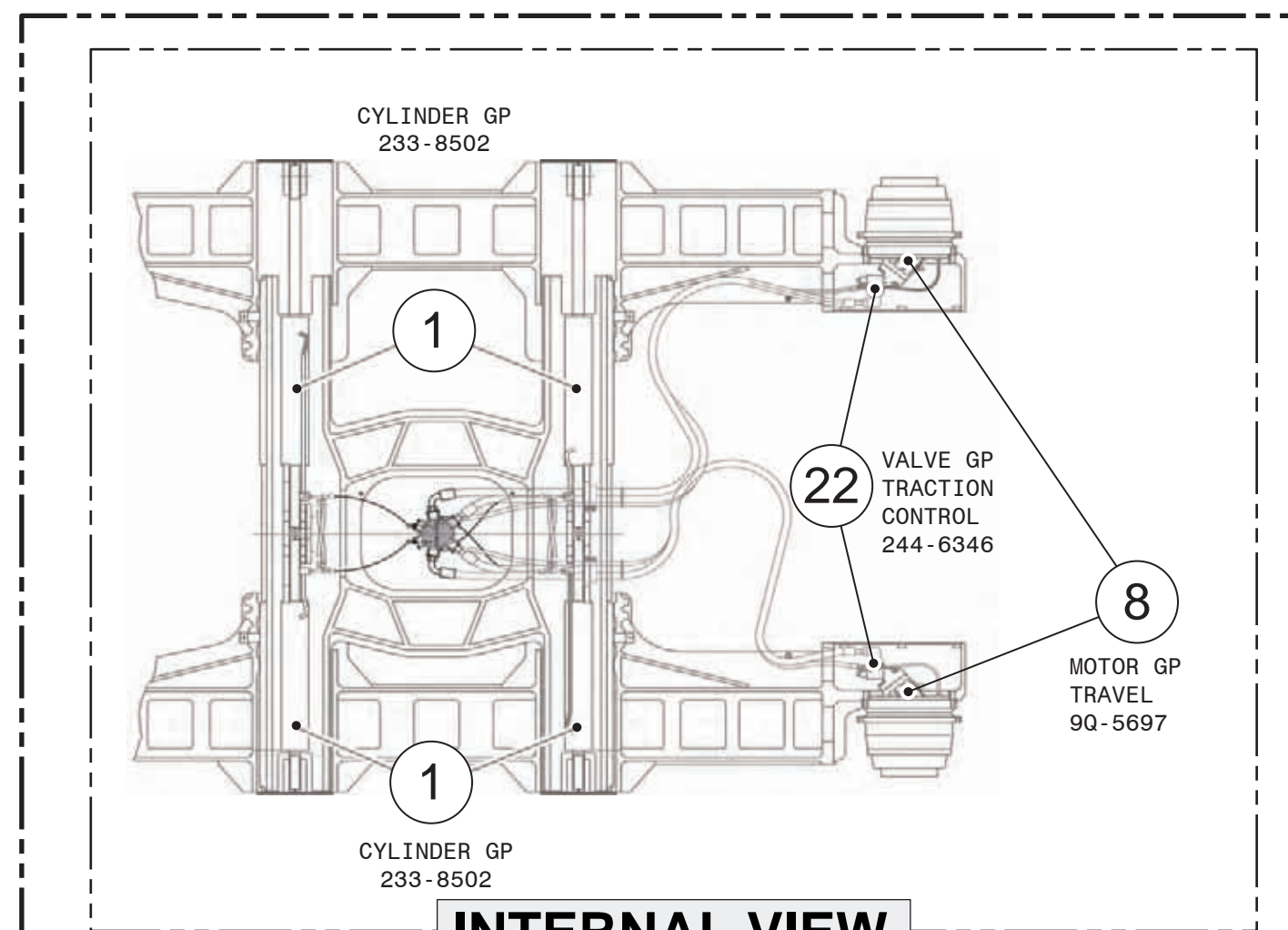

INTERNAL VIEW

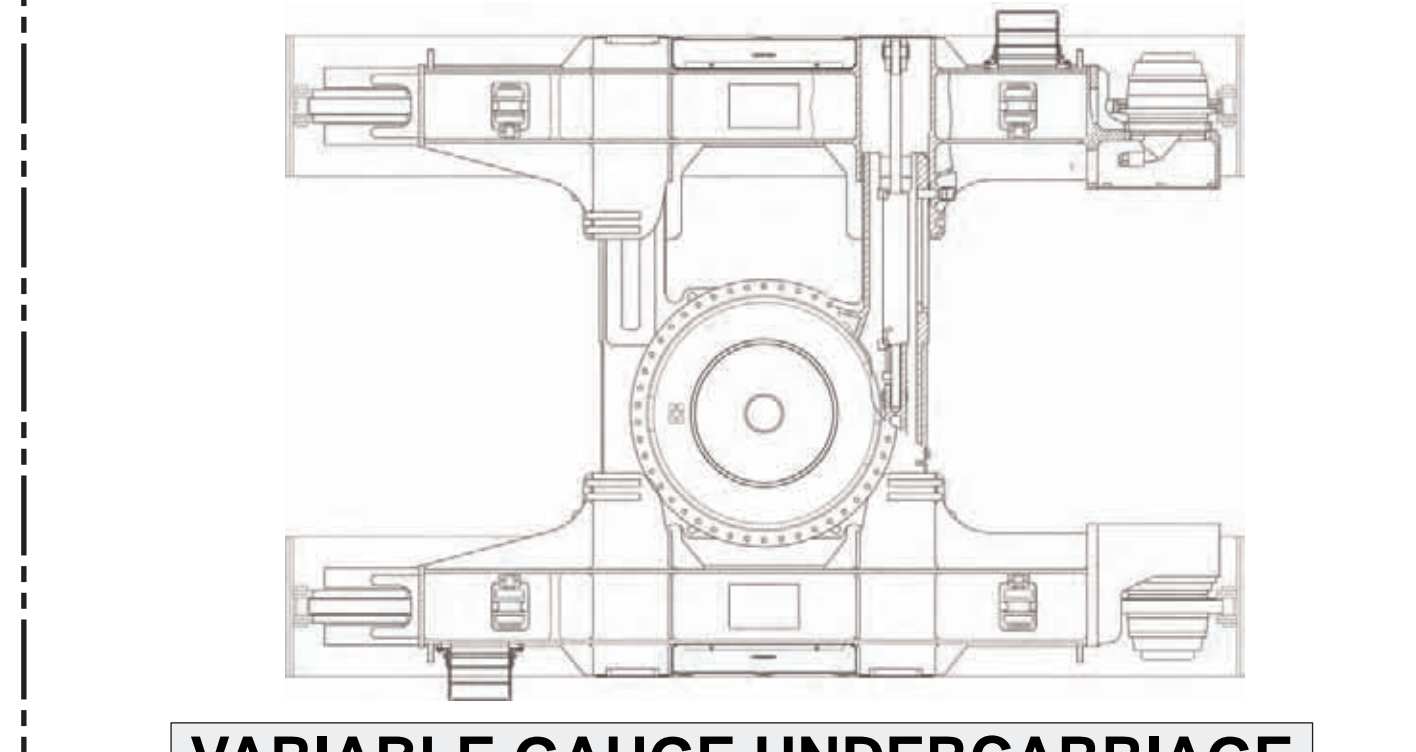

VARIABLE GAUGE UNDERCARRIAGE

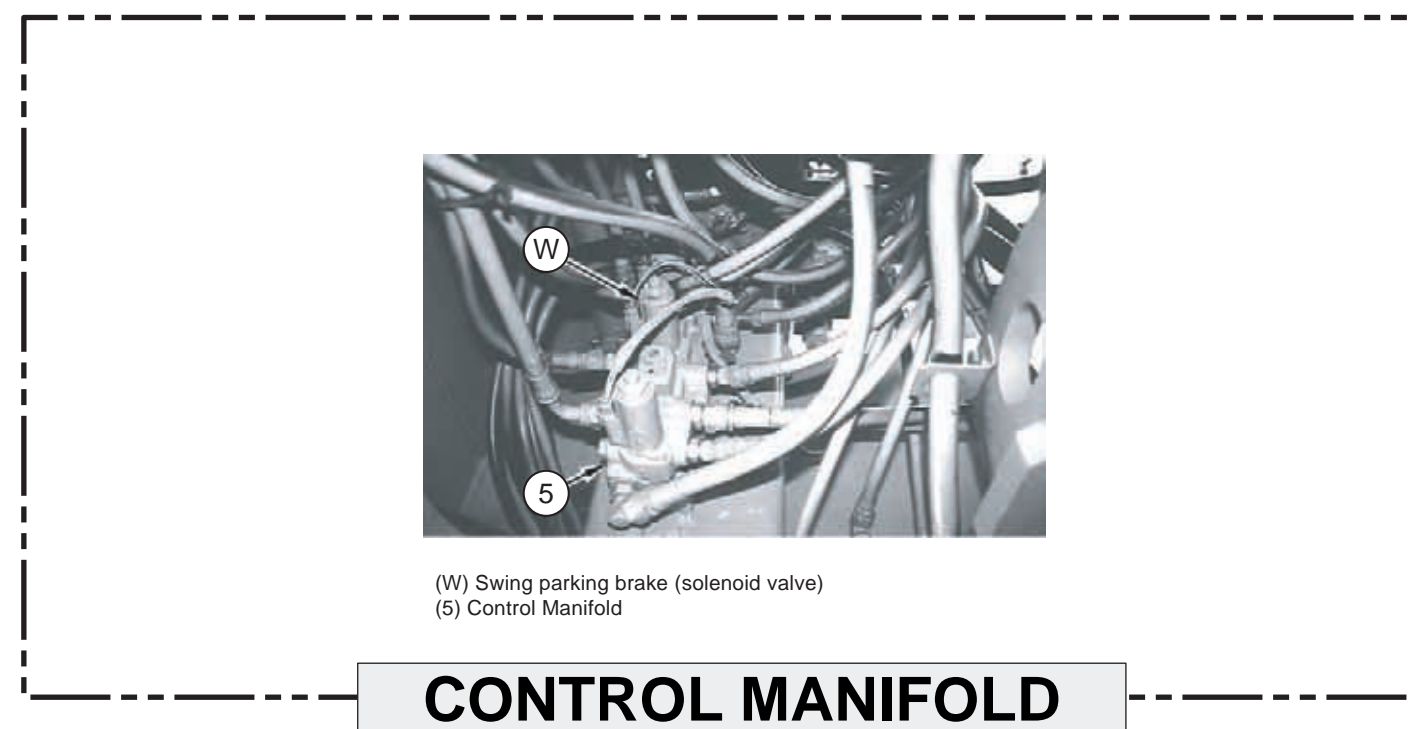

CONTROL MANIFOLD

Electrical Symbols Table			
Hydraulic Symbols (Electrical)			
Transducer (Fluid)	Transducer (Gas / Air)	Generator	Electric Motor
Pressure Switch	Pressure Switch (Adjustable)	Temperature Switch	Electrical Wire
Electrical Symbols (Electrical)			
Pressure Symbol	Temperature Symbol	Level Symbol	Flow Symbol
Wire Number Identification Codes			
Electrical Schematic Example		Hydraulic Schematic Example	
<p>Current Standard</p> <p>Harvest identification code This example indicates wire 135 in harness 'AG'.</p> <p>Wire Color: 325-AG135-PK-14</p> <p>Wire Gauge: 14</p> <p>Circuit Identification Number: 325-AG135-PK-14</p>		<p>Current Standard</p> <p>Circuit Number Identification: 325-PK</p> <p>Wire Color: PK</p> <p>Wire Gauge: 14</p> <p>325-PK-14</p> <p>Circuit Number Identification: 325-PK-14</p>	
<p>Previous Standard</p> <p>Wire Color: 325-PK-14</p> <p>Wire Gauge: 14</p> <p>Circuit Number Identification: 325-PK-14</p>		<p>325-PK-14</p> <p>Circuit Number Identification: 325-PK-14</p> <p>(EXAMPLE VALVE)</p>	

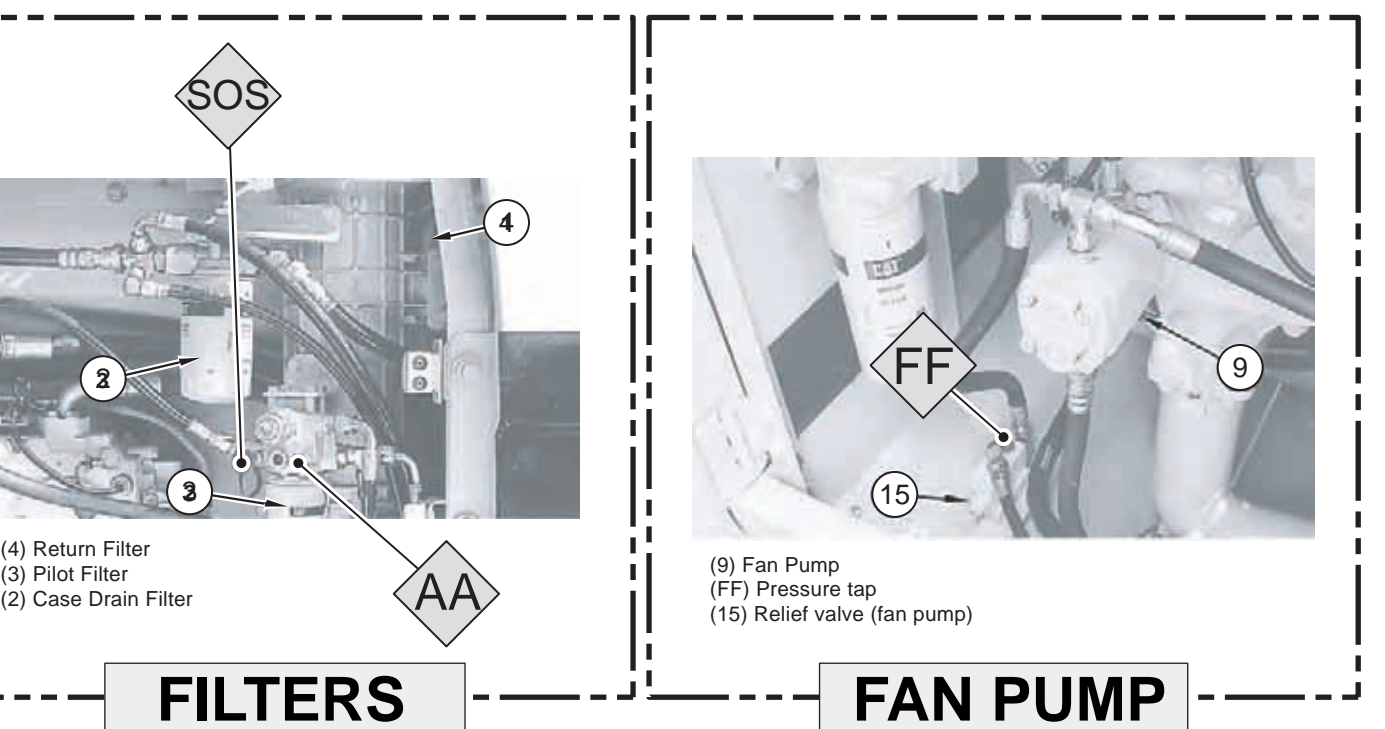

FILTERS

FAN PUMP

www.manuals-free.com

KENR7846
 24 Page, (Dimensions: 34 inches x 28 inches)

KENR7846
24 Page, (Dimensions: 34 inches x 28 inches)

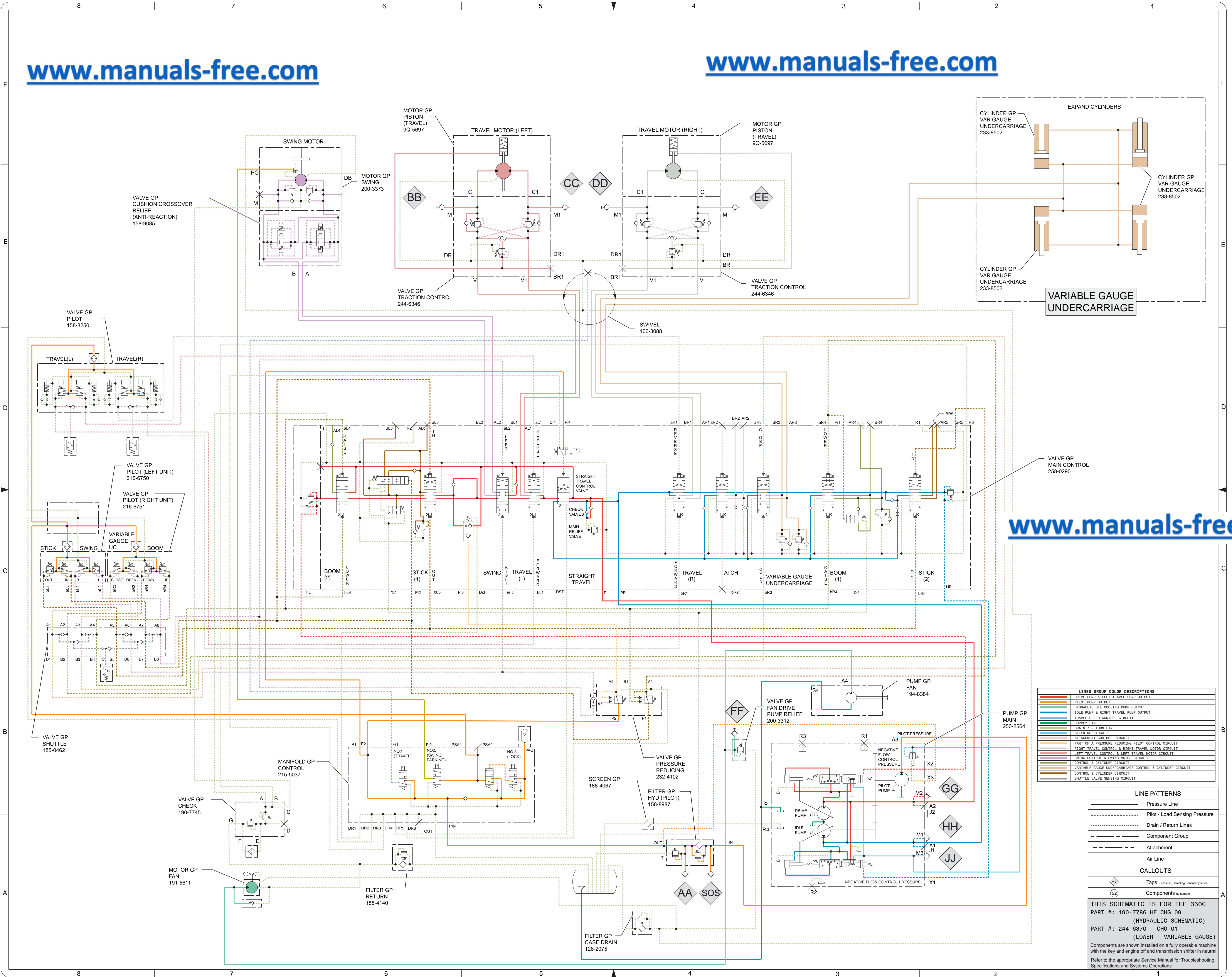

LINE GROUP COLOR DESCRIPTIONS

Red	DRIVE PUMP & LEFT TRAVEL PUMP OUTPUT
Orange	PILOT PUMP OUTPUT
Green	HYDRAULIC OIL COOLING PUMP OUTPUT
Blue	IDLE PUMP & RIGHT TRAVEL PUMP OUTPUT
Yellow	TRAVEL SPEED CONTROL CIRCUIT
Purple	SUPPLY LINE
Brown	DRAIN / RETURN LINE
Pink	STEERING CIRCUIT
Light Blue	ATTACHMENT CONTROL CIRCUIT
Light Green	PART OF A PRESSURE SENSING PILOT CONTROL CIRCUIT
Light Orange	RIGHT TRAVEL CONTROL & RIGHT TRAVEL MOTOR CIRCUIT
Light Purple	LEFT TRAVEL CONTROL & LEFT TRAVEL MOTOR CIRCUIT
Light Yellow	SWING CONTROL & SWING MOTOR CIRCUIT
Light Blue-Gray	CONTROL & CYLINDER CIRCUIT
Light Green-Gray	VARIABLE GAUGE UNDERCARRIAGE CONTROL & CYLINDER CIRCUIT
Light Orange-Gray	CONTROL & CYLINDER CIRCUIT
Light Purple-Gray	SHUTTLE VALVE SENSING CIRCUIT

LINE PATTERNS

Red line	Pressure Line
Orange line	Pilot / Load Sensing Pressure
Green line	Drain / Return Lines
Blue line	Component Group
Yellow line	Attachment
Purple line	Air Line

CALLOUTS

Symbol	TapPS (Pressure Sensing Port) by letter
Symbol	Components by number

THIS SCHEMATIC IS FOR THE 330C
 PART #: 190-7786 HE CHG 09
 (HYDRAULIC SCHEMATIC)
 PART #: 244-6370 - CHG 01
 (LOWER - VARIABLE GAUGE)

Components are shown installed on a fully operable machine with the key and engine off and transmission shifter in neutral. Refer to the appropriate Service Manual for Troubleshooting, Specifications and Systems Operations.