

Component Locations			
Description	Part Number	Machine Location	Schematic Location
Bonnet - Oil Cooler, Pwrtrn Manifold	238-1117	1	D-7
Cap AS - Radiator, Shunt Tank	294-2342	2	D-4
Coil AS - Cab Heater	292-5271	3	B-7
Control GP - ACC Pwr Converter	287-5818	4	B-1
Converter GP - (BTP Inverter)	287-6671	5	C-1
Core AS - Engine Oil Cooler	187-8950	6	D-6
Core AS - Oil Cooler, Hydraulic Oil	308-3405	7	C-3
Core AS - Pwrtrn Oil Cooler	187-3523	8	C-7
Core AS - Radiator, Jacket Water	235-1238	9	D-5
Generator GP	303-3061	10	D-2
Head GP - Cylinder, Basic	293-4670	11	E-6
Head GP - Cylinder (A), Block	293-4670	12	E-7
Pump GP - Coolant	314-9285	13	C-4
Radiator AS - Separate Circuit	255-1240	14	C-3
Regulator - Temperature	297-6985	15	E-5
Sensor - Temp., Jacket Water	256-6453	16	E-6
Sensor - Temp., Separate Circuit	256-6453	17	C-2
Tank AS - Coolant	317-6945	18	D-4
Valve - Ball, Drain, Generator Coolant	156-2525	19	C-2
Valve - Ball, Drain, Radiators	156-2525	20	C-5
Valve AS	298-6173	21	C-6
Valve AS - Check	311-4612	22	C-2
Valve AS - Check	311-4612	23	C-4
Valve AS - Shutoff	6V-7238	24	B-5
Valve AS - Shutoff	6V-7238	25	B-5
Valve AS - Shutoff	112-4036	26	B-6
Valve AS - Shutoff	112-4036	27	B-6
Valve AS - Shutoff	112-4036	28	B-6
<b>Optional</b>			
Heater GP - 120V/15A., Jacket Water	261-0783	29	D-7
Heater GP - 240V/7.5A., Jacket Water	261-0784	29	D-7
Turbo GP	315-8004	30	C-6

Tap Locations Pressure and Sampling		
Tap Number	Description	Schematic Location
SOS	Water Jacket Coolant Sampling	E-6

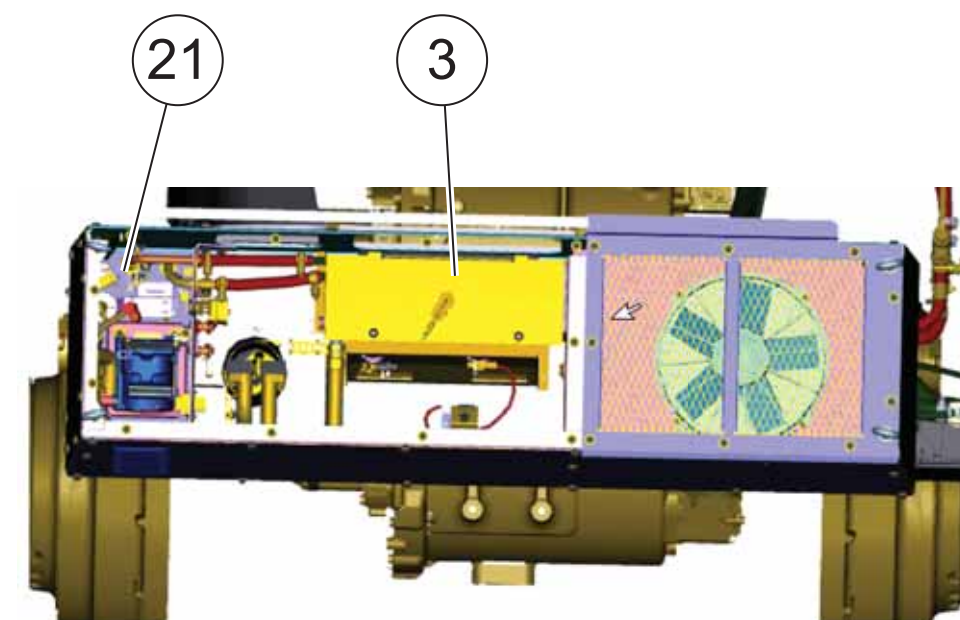

TOP VIEW, RIGHT SIDE OF ENGINE

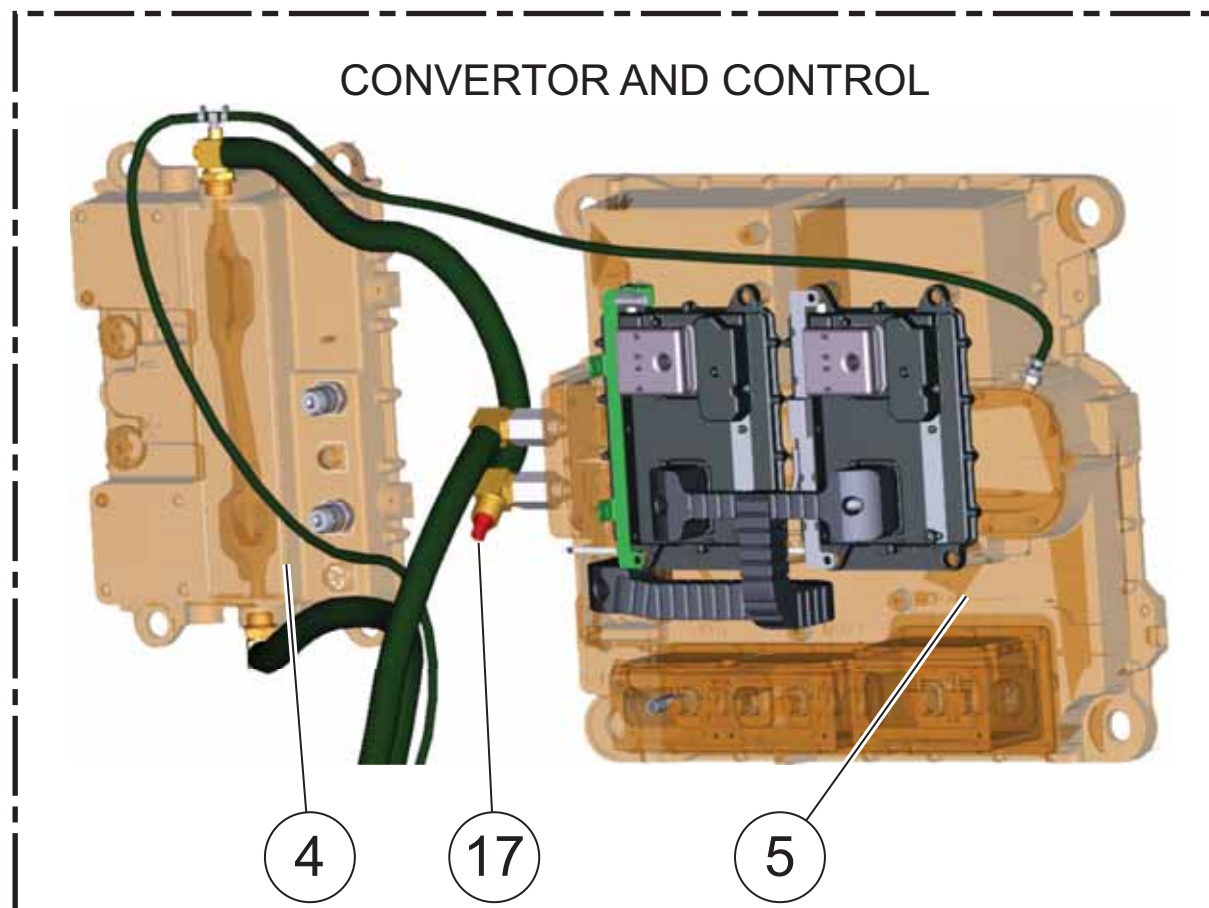
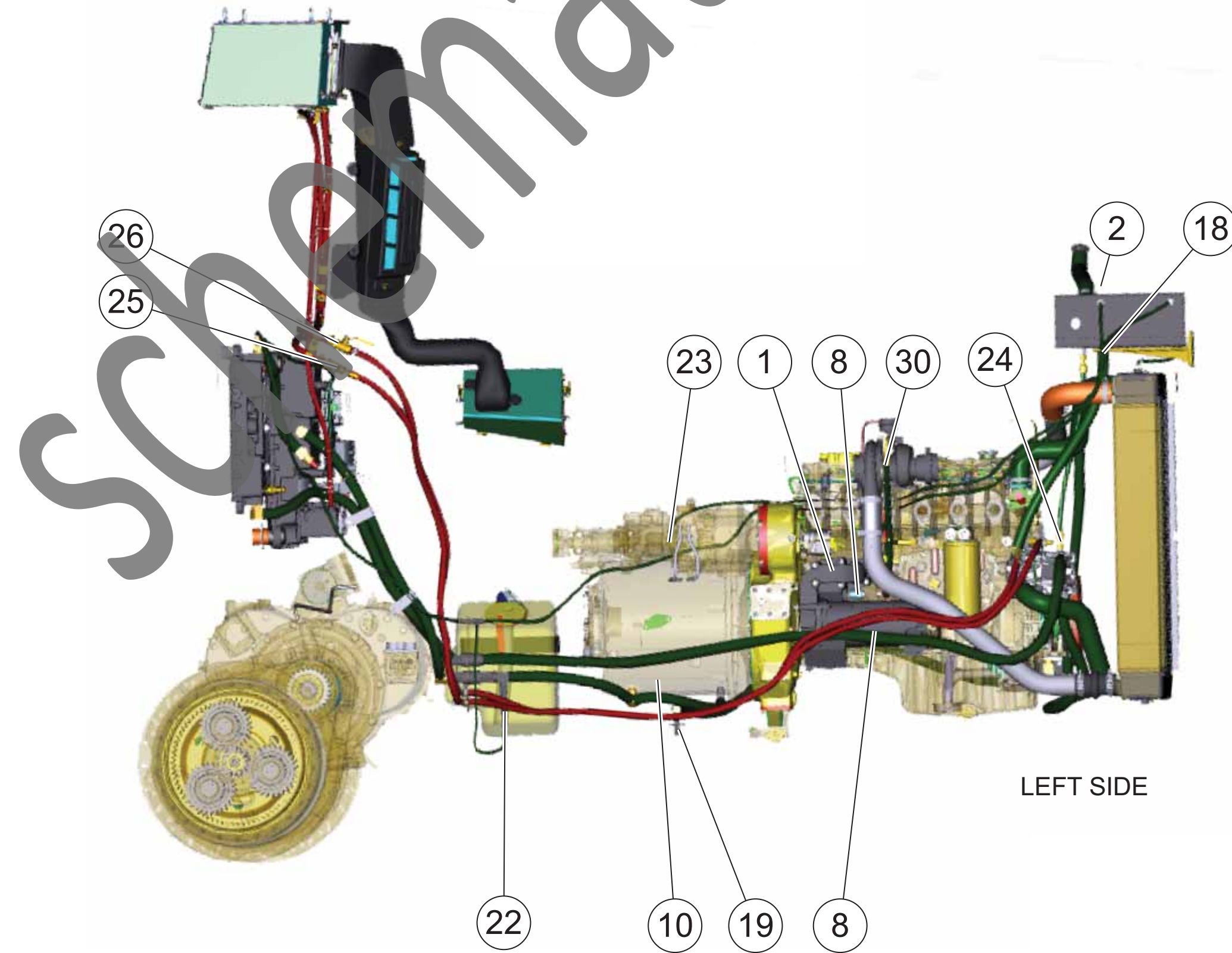
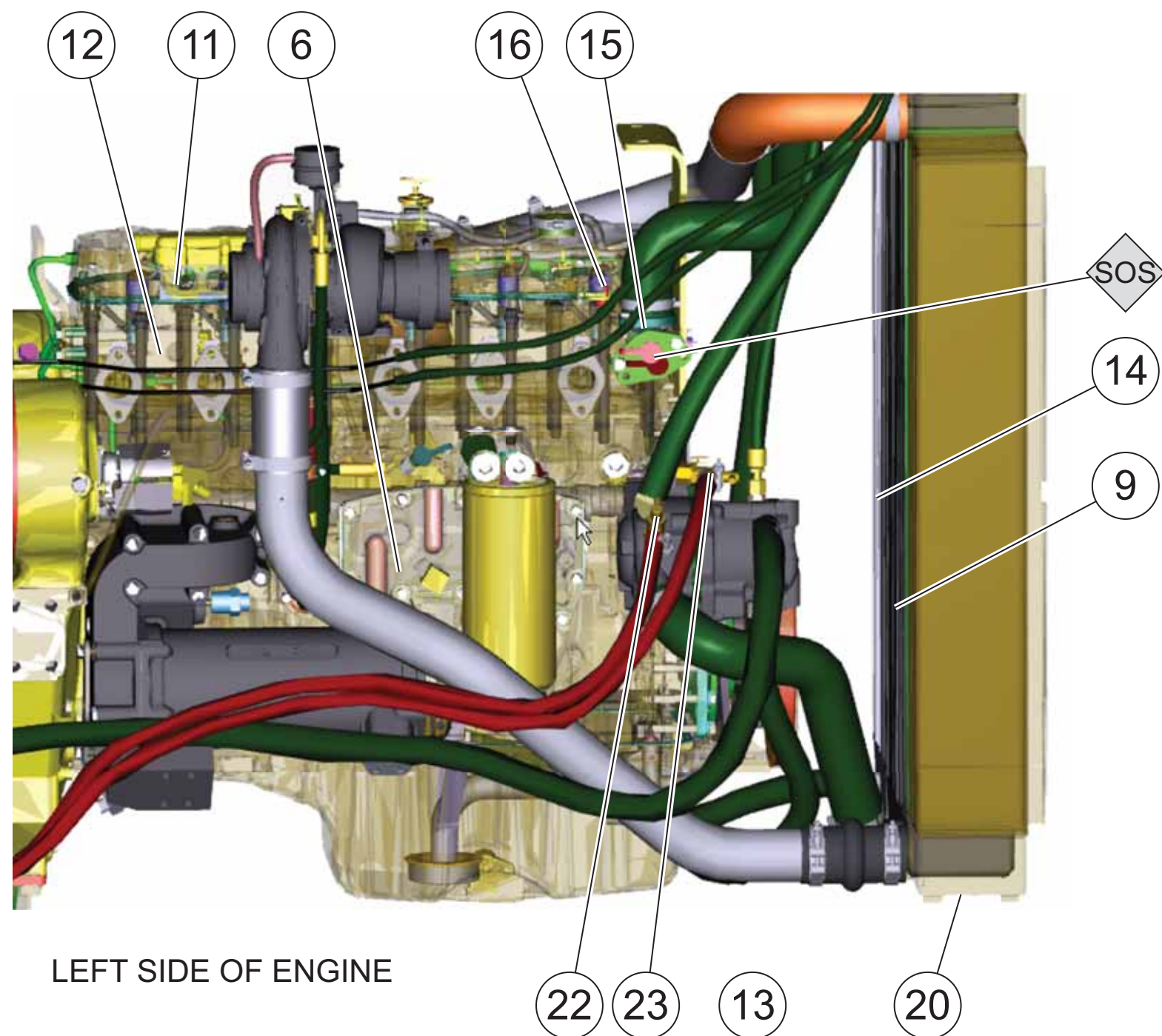
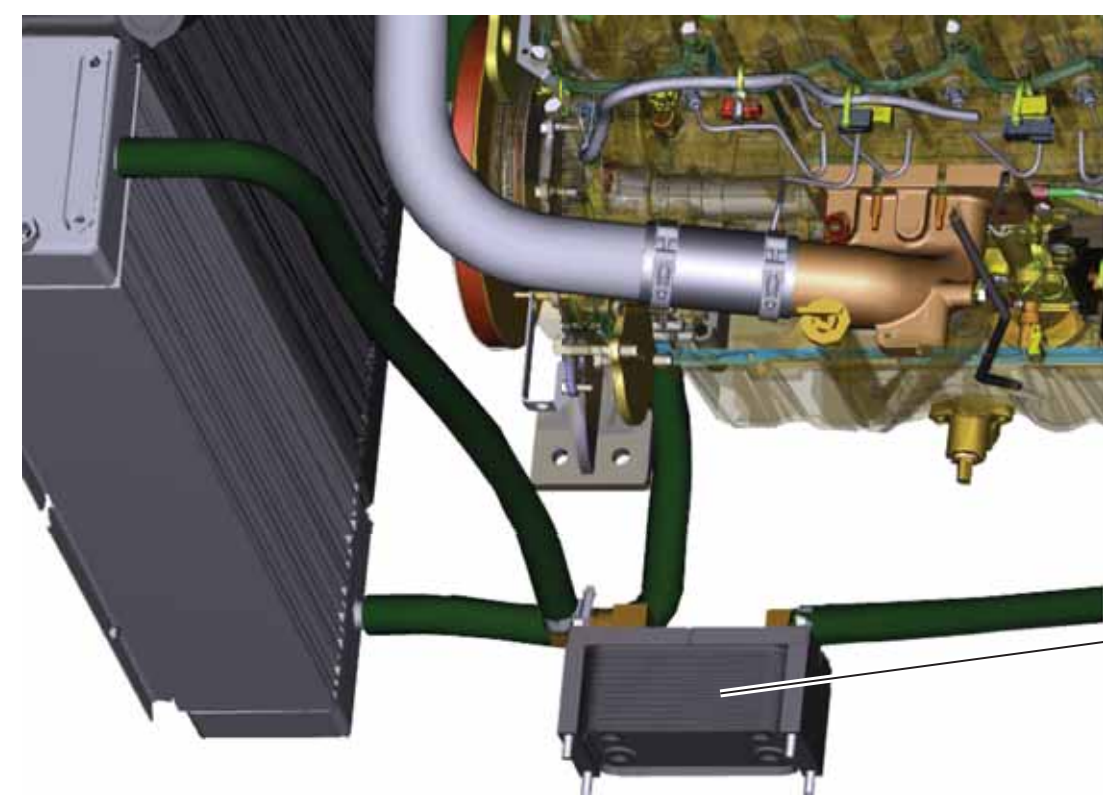

COMPONENT LOCATIONS

# Schematic

## D7E2 Track-Type Tractor Cooling System

TJA1-UP  
TAN1-UP

© 2012 Caterpillar, All Rights Reserved

Printed in U.S.A.

FLUID POWER SYMBOLS		
<b>BASIC COMPONENT SYMBOLS</b>		
PUMP OR MOTOR	FLUID CONDITIONER	SPRING
CONTROL VALVES	RESTRICTION	LINE RESTRICTION (FIXED)
LINE RESTRICTION (VARIABLE)	PNEUMATIC ENERGY TRIANGLES	HYDRAULIC ENERGY TRIANGLES
VARIABLE	SPRING (ADJUSTABLE)	LINE RESTRICTION (VARIABLE)
PRESSURE COMPENSATION	HYDRAULIC ENERGY TRIANGLES	PNEUMATIC ENERGY TRIANGLES
LINE RESTRICTION (VARIABLE & PRESSURE COMPENSATED)	ATTACHMENT	
<b>VALVE ENVELOPES</b>		
ONE POSITION	TWO POSITION	THREE POSITION
<b>VALVES</b>		
TWO-WAY	THREE-WAY	FOUR-WAY
<b>CONTROL VALVES</b>		
NORMAL POSITION	SHIFTED POSITION	INFINITE POSITION
<b>CHECK VALVES</b>		
BASIC SYMBOL	SPRING LOADED	SHUTTLE
<b>FLUID STORAGE RESERVOIRS</b>		
VENTED	PRESSURIZED	RETURN ABOVE FLUID LEVEL
RETURN BELOW FLUID LEVEL		
<b>MEASUREMENT</b>		
PRESSURE	TEMPERATURE	FLOW
<b>ROTATING SHAFTS</b>		
UNIDIRECTIONAL	BIDIRECTIONAL	
<b>COMBINATION CONTROLS</b>		
SOLENOID	SOLENOID OR MANUAL	SOLENOID & PILOT
SOLENOID & PILOT OR MANUAL	SERVO	THERMAL
<b>MANUAL CONTROL SYMBOLS</b>		
PUSH-PULL LEVER	MANUAL SHUTOFF	GENERAL MANUAL
PUSH BUTTON	PEDAL	SPRING
<b>RELEASED PRESSURE</b>		
EXTERNAL RETURN	INTERNAL RETURN	SIMPLIFIED
<b>PILOT CONTROL SYMBOLS</b>		
COMPLETE	INTERNAL SUPPLY PRESSURE	
<b>ACCUMULATORS</b>		
SPRING LOADED	GAS CHARGED	
<b>CROSSING &amp; JOINING LINES</b>		
LINES CROSSING	LINES JOINING	
<b>HYDRAULIC &amp; PNEUMATIC CYLINDERS</b>		
SINGLE ACTING	DOUBLE ACTING	
<b>INTERNAL PASSAGeways</b>		
INFINITE POSITIONING	3 POSITION	2 POSITION
FLOW IN ONE DIRECTION	PARALLEL FLOW	CROSS FLOW
FLOW IN EITHER DIRECTION		

ELECTRICAL SYMBOLS TABLE			
<b>HYDRAULIC SYMBOLS (ELECTRICAL)</b>			
TRANSDUCER (FLUID)	TRANSDUCER (GAS / AIR)	GENERATOR	ELECTRIC MOTOR
PRESSURE SWITCH	PRESSURE SWITCH (ADJUSTABLE)	TEMPERATURE SWITCH	ELECTRICAL WIRE
<b>ELECTRICAL SYMBOLS (ELECTRICAL)</b>			
PRESSURE SWITCH	TEMPERATURE SWITCH	LEVEL SWITCH	FLOW SWITCH
<b>WIRE NUMBER IDENTIFICATION CODES</b>			
<b>ELECTRICAL SCHEMATIC EXAMPLE CURRENT STANDARD</b>		<b>HYDRAULIC SCHEMATIC EXAMPLE CURRENT STANDARD</b>	
HARNES IDENTIFICATION CODE THIS EXAMPLE INDICATES WIRE 135 IN HARNES "AG"		CIRCUIT NUMBER IDENTIFICATION	
325-AG-135-PK-14	WIRE GAUGE	325-PK	WIRE COLOR
CIRCUIT NUMBER IDENTIFICATION	WIRE COLOR	(EXAMPLE VALVE)	
<b>PREVIOUS STANDARD</b>			
325-PK-14	WIRE GAUGE		
CIRCUIT NUMBER IDENTIFICATION	WIRE COLOR		



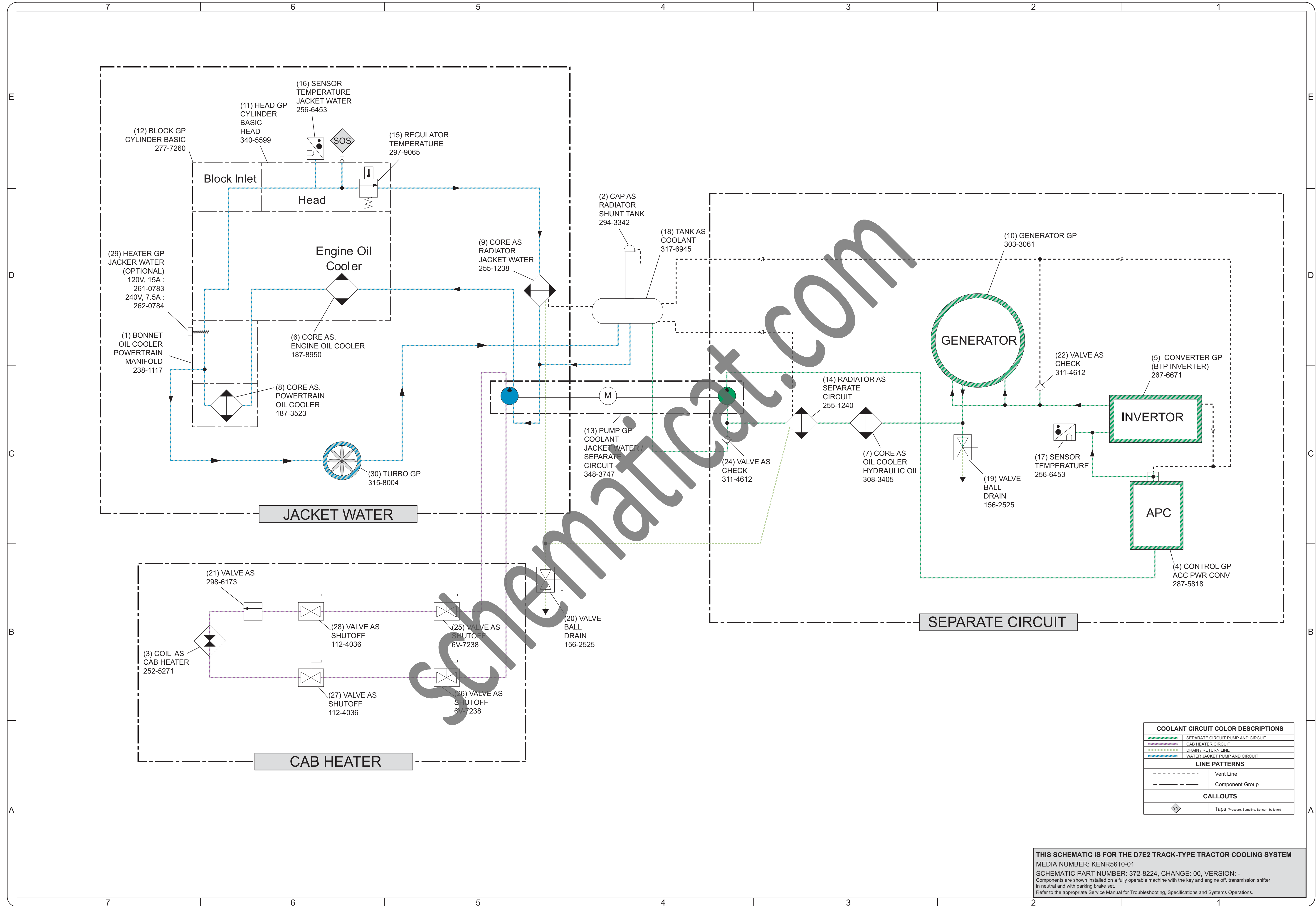

COOLANT CIRCUIT COLOR DESCRIPTIONS	
	SEPARATE CIRCUIT PUMP AND CIRCUIT
	CAB HEATER CIRCUIT
	DRAIN / RETURN LINE
	WATER JACKET PUMP AND CIRCUIT
LINE PATTERNS	
	Vent Line
	Component Group
CALLOUTS	
	Taps (Pressure, Sampling, Sensor - by letter)

**THIS SCHEMATIC IS FOR THE D7E2 TRACK-TYPE TRACTOR COOLING SYSTEM**  
 MEDIA NUMBER: KENR5610-01  
 SCHEMATIC PART NUMBER: 372-8224, CHANGE: 00, VERSION: -  
 Components are shown installed on a fully operable machine with the key and engine off, transmission shifter in neutral and with parking brake set.  
 Refer to the appropriate Service Manual for Troubleshooting, Specifications and Systems Operations.