

Component Locations			
Description	Part Number	Machine Location	Schematic Location
Breather	9G-6127	1	D-5
Core AS - Oil Cooler	187-3523	2	B-2
Filter GP - Power Train Oil	295-0711	3	E-2
Generator GP	303-3061	4	C-3
Propulsion GP - Electric	245-0250	5	C-7
Pump GP - Scavenge / Lube	313-4565	6	B-4
Screen AS - Suction	SP-0217	7	B-5
Sensor GP - Temperature, PT Oil	145-7028	8	C-4
Tank AS - Powertrain Oil	310-3272	9	D-5
Valve GP - Relief, Cold Oil	148-1928	10	D-4
Valve GP - Test (Brake)	309-3012	11	C-6

Tap Locations Pressure and Sampling		
Tap Number	Description	Schematic Location
L1	Lube Oil Pressure	D-7
SOS	Lube Oil Sampling	D-2

# Schematic

## D7E Track-Type Tractor Power Train System

TJA1-UP  
TAN1-UP

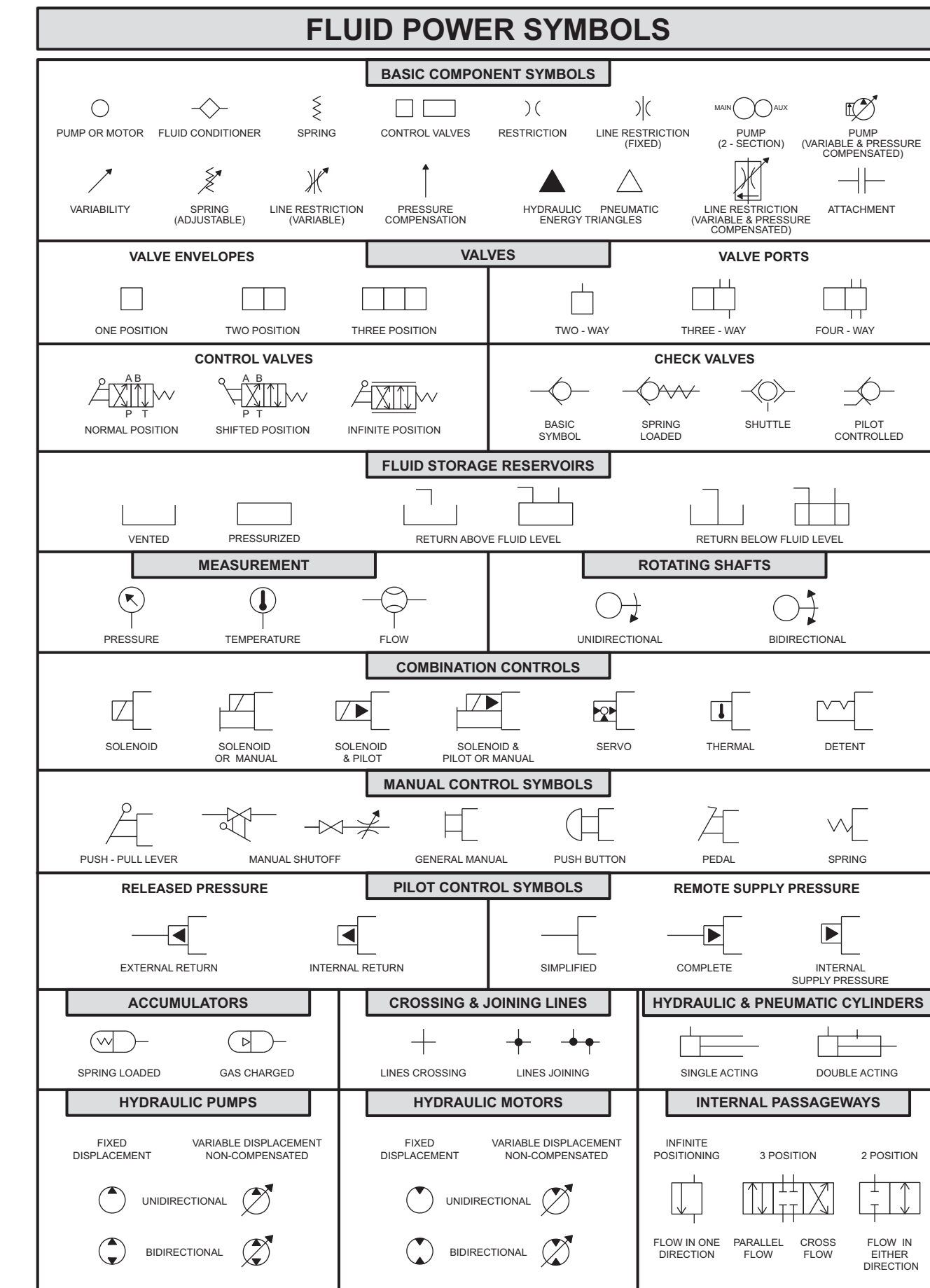

© 2011 Caterpillar, All Rights Reserved

Printed in U.S.A.

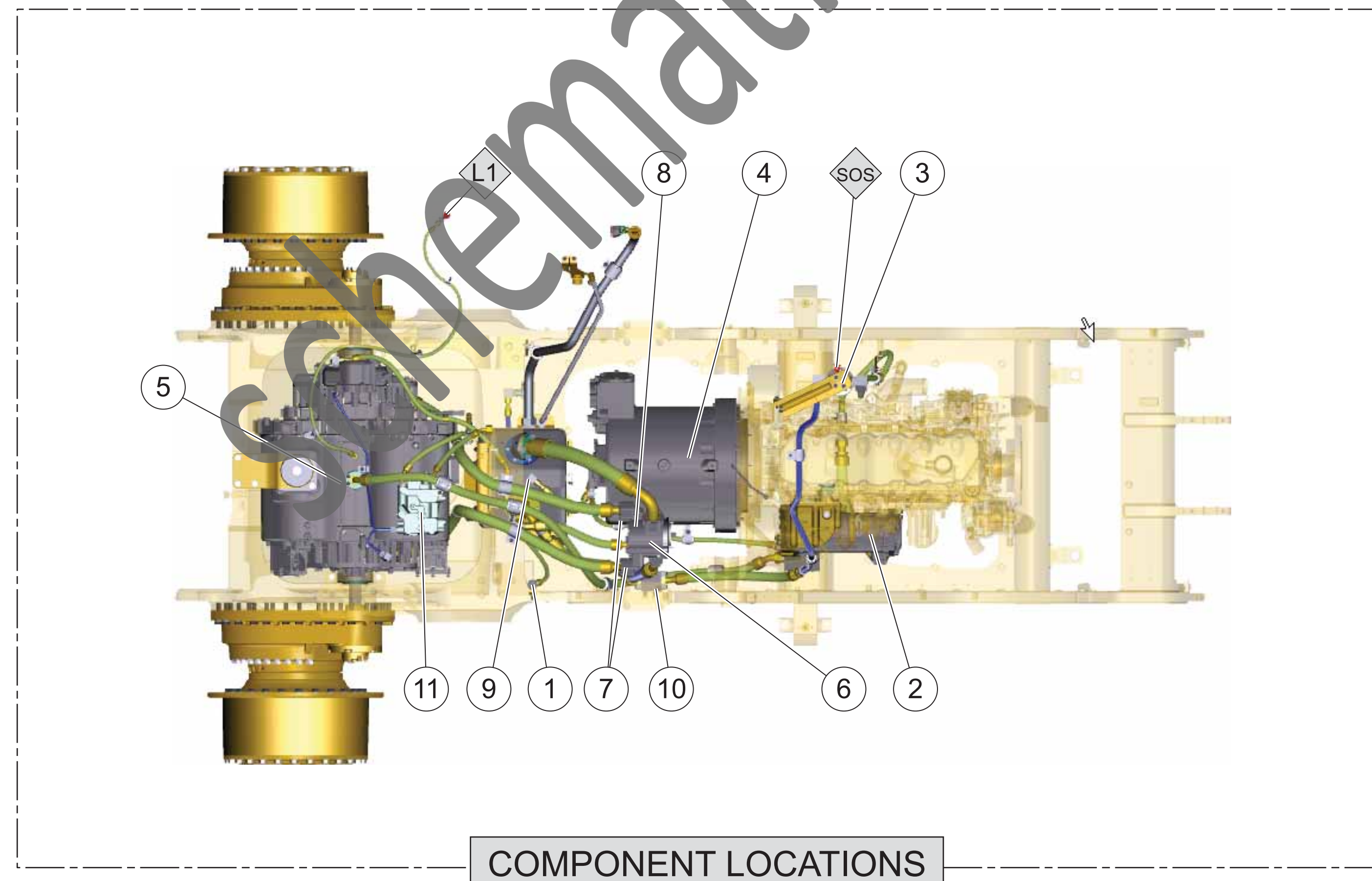

COMPONENT LOCATIONS

