

Date	Group	No.	Release	Page
6.10	<b>370</b>	<b>162</b>	<b>01</b>	1(10)

This service bulletin complements Service Handbook Group 37 88917352 and 88917383

Wiring diagram

Changed fuses

FL, FE

CHID B564590-

## Wiring diagram, changed fuses

### Contents

FL diagram GA1 "", page 2

FL diagram GF "", page 3

FL diagram HY "", page 4

"EJB FL", page 5

FE diagram AG "", page 6

FE diagram GA1 "", page 7

FE diagram HY "", page 8

FE diagram IR1 "", page 9

"EJB FE", page 10



T3056877

WIRING DIAGRAM GF

Trailer connections

4

3

2

1

0

MAIN / 30  
IGNITION / 15 / DR

A

B

C

D

E

INSTR. CLUSTER

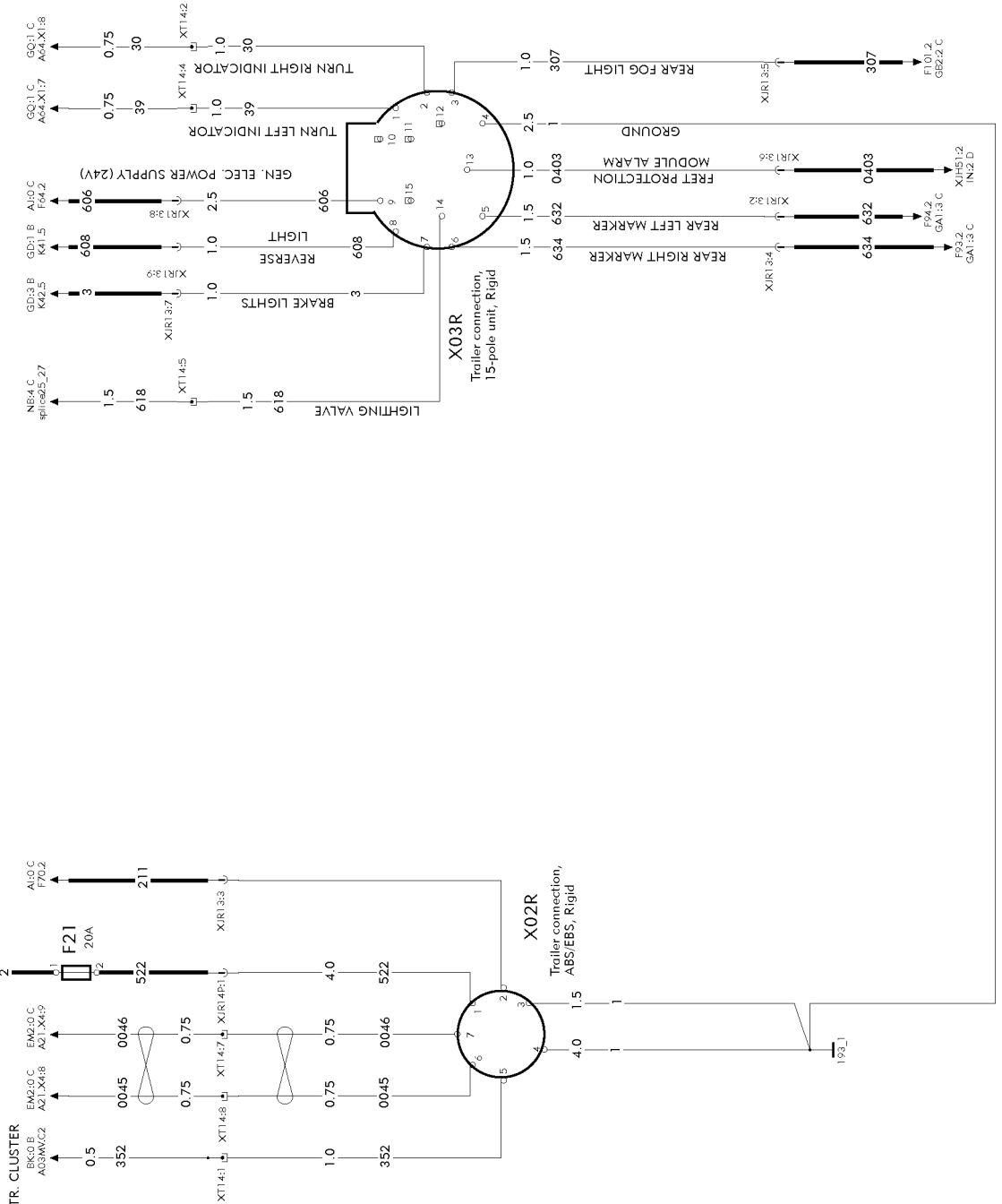

MAIN / 30  
IGNITION / 15 / DR

WIRING DIAGRAM HY

Climate unit

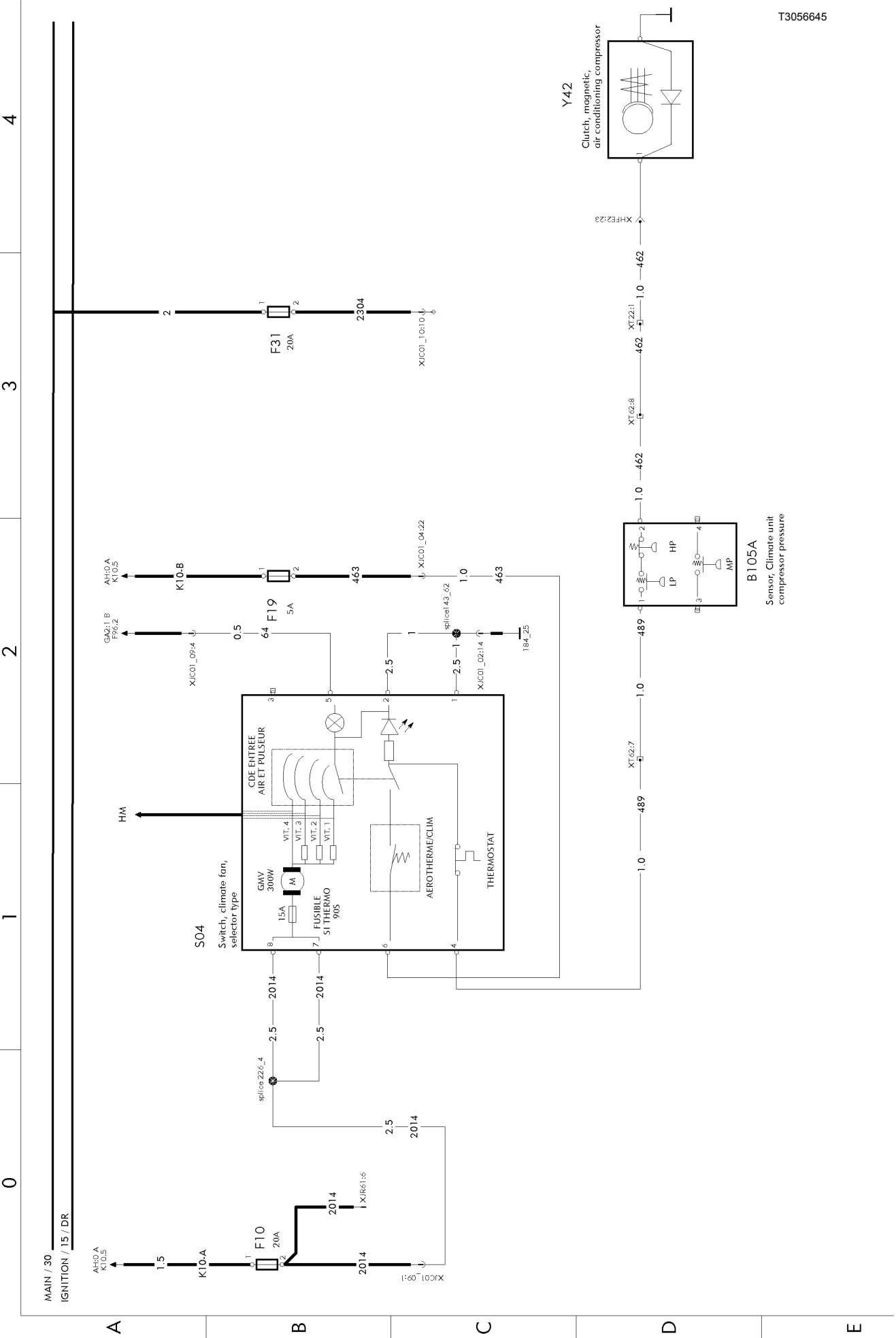

T3056645

## EJB FL

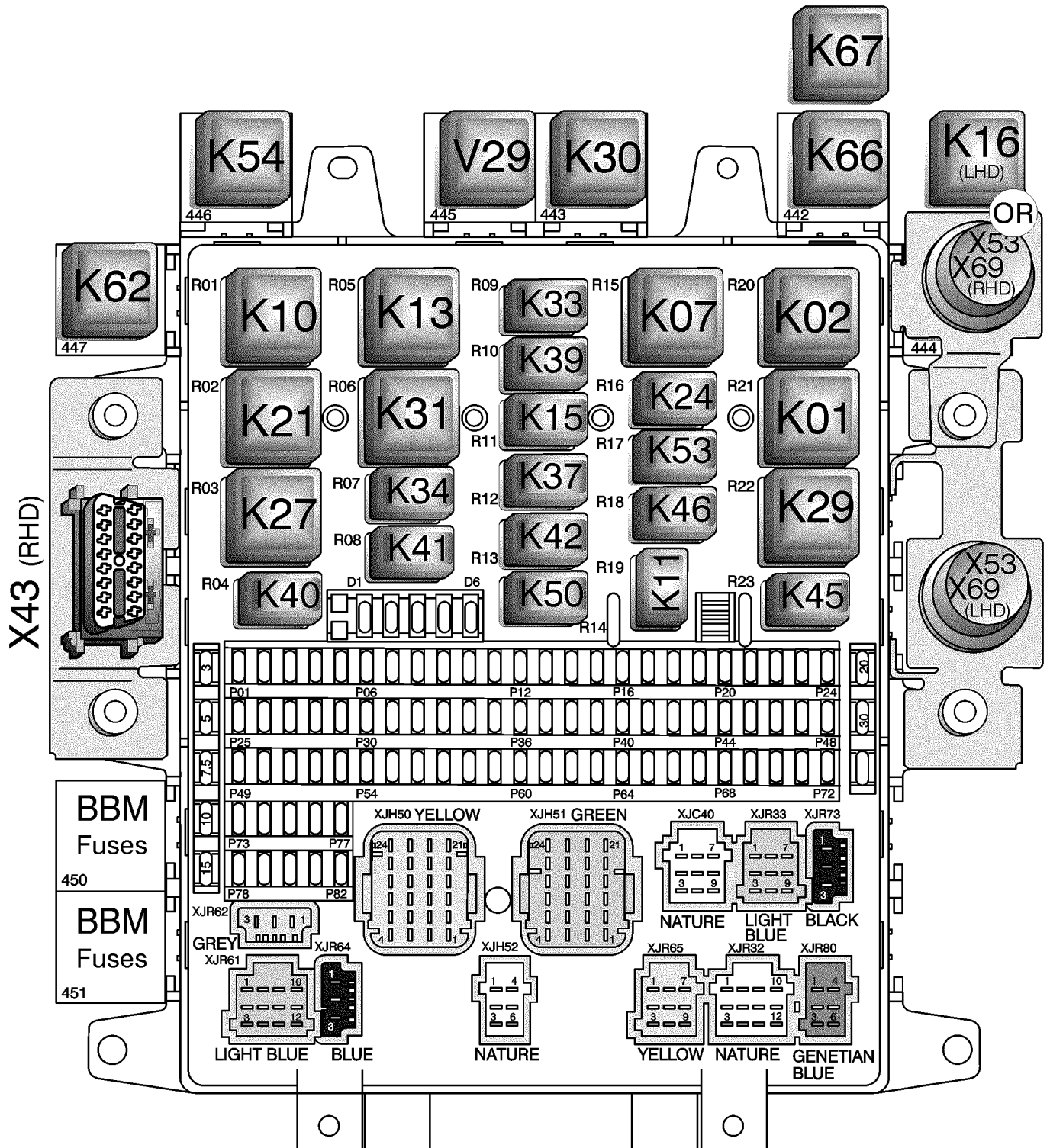

T3021087

### Changed fuses

F10, climate unit, 15A fuse is replaced by 20A fuse (pos.76).

F93, parking lighting trailer/body builder connector 10A fuse is replaced by 15A fuse (pos.52).

F94, parking lighting trailer/body builder connector 10A fuse is replaced by 15A fuse (pos.53).





WIRING DIAGRAM HY

Climate unit

T3056643

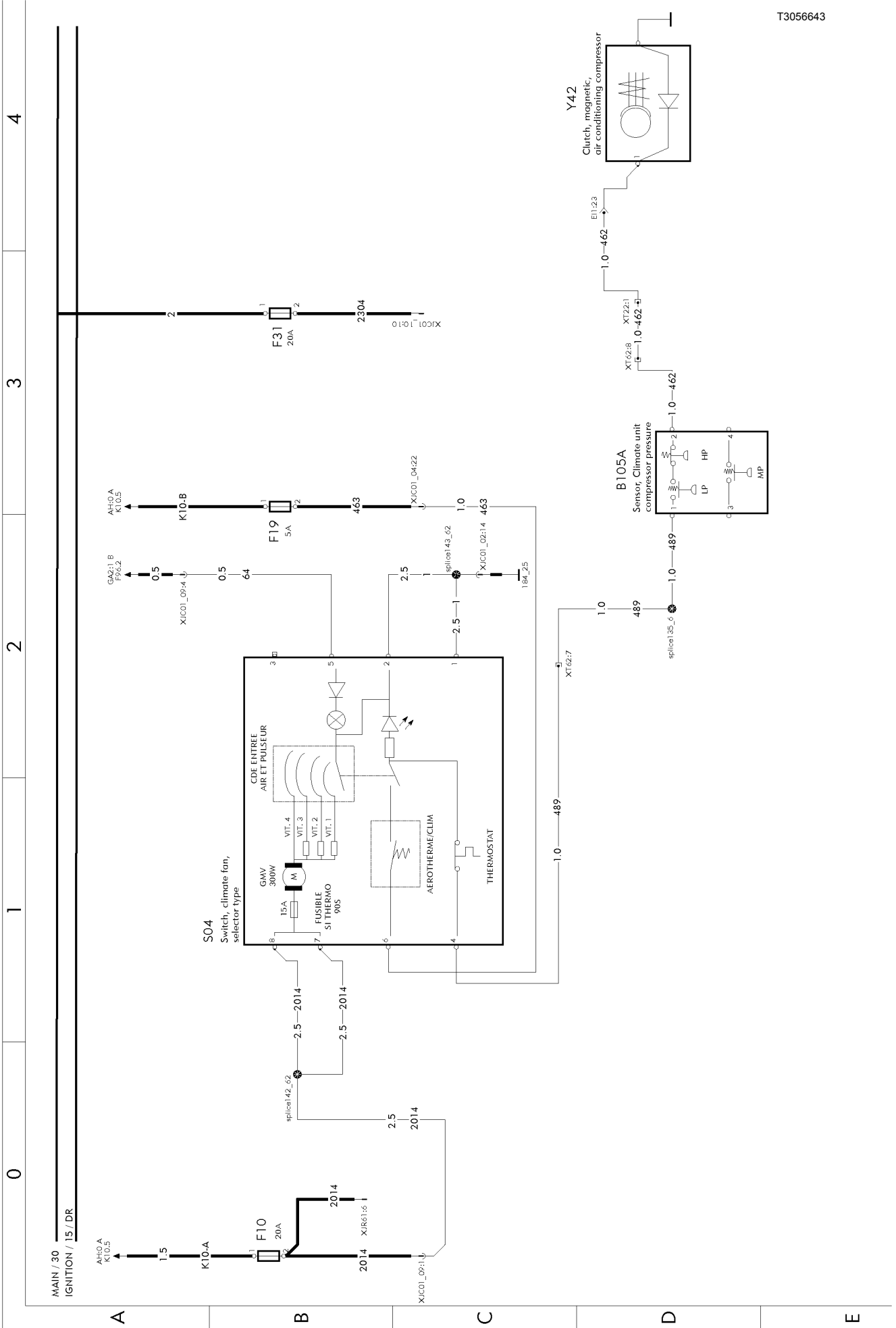





## EJB FE

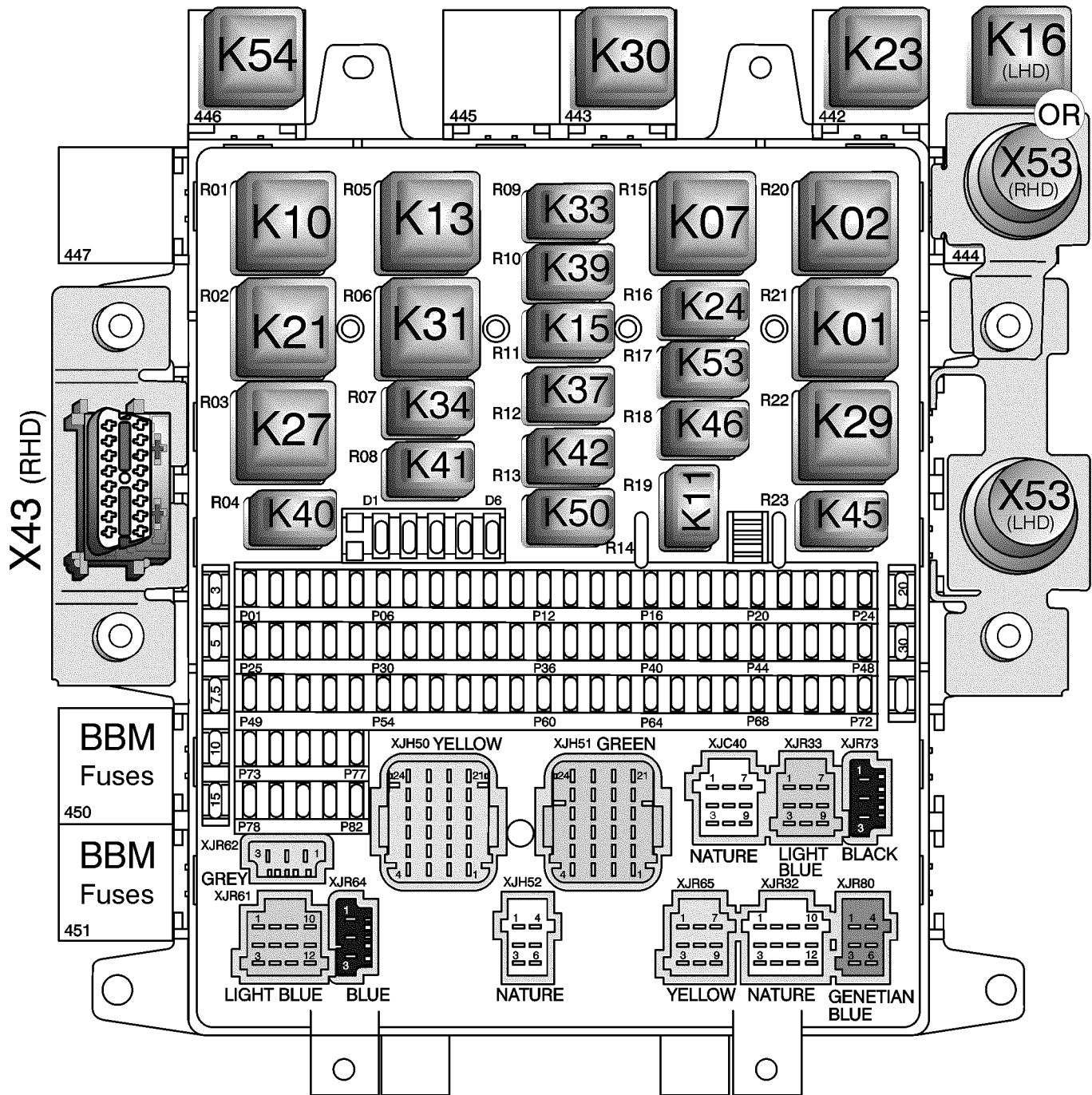

T3021535

### Changed fuses

F10, climate unit, 15A fuse is replaced by 20A fuse (pos.76).

F93, parking lighting trailer/body builder connector 10A fuse is replaced by 15A fuse (pos.52).

F94, parking lighting trailer/body builder connector 10A fuse is replaced by 15A fuse (pos.53).