

DD13 GHG17 (front)

- | | | |
|--|---|--|
| <ol style="list-style-type: none"> 1. CYLINDER HEAD/ W/O VALVES, SH.0 AND SF. 2. BOLT CYLINDER HEAD M15 X 192 3. HIGH-PRESSURE LINE 4. SCREW HEX MBN 10105-M6 X 25 - 12 - 12.9 5. SEALING FOR INJECTOR LINE 6. CAMSHAFT HOUSING COMPL-MY16 7. CYLINDER HEAD COVER 8. AIR FILTER SUPPORT BRACKET 9. BOLT HEX HEAD FLANGE M8X1.25X90-10.9 10. HEX SCREW MBN 10105-C M 8X 70 11. AIR FILTER SUPPORT BRACKET 12. WARNING SIGN-ENGINE LIFTING 13. SPEED SENSOR CAMSHAFT 14. HIGH-PRESSURE LINE 15. HEXHDBOLT MBN 10105-M 6X 12 16. HIGH-PRESSURE LINE MY16 17. BRACKET HIGH PRESSURE FUEL LINES 18. BRACKET 19. SCREW HEX MBN 10105-M 6X 16 20. SPHERICAL COLLAR BOLT M6 X 1.0 21. TENSIONING BRACKET 22. DD13 FE1 RAIL-MY16 23. WARNING SIGN-HIGH PRES. FUEL 24. TENSIONING BRACKET 25. VALVE STEM SEAL 26. O-RING 27. CLOSING COVER 28. BOLT HEX HEAD FLANGE M8X1.25X16-10.9 29. INJECTOR 30. VALVE COLLAR 31. VALVE SPRING CAP 32. SPRING VALVE 33. WASHER CYLINDER HEAD 29.5 O.D. 16.5 I.D.X 0.5 34. EXHAUST VALVE 35. INTAKE VALVE 36. CSR 1.5MM TPR L161 DEL 60XCW 37. HEXAGONAL BOLT 38. TENSIONING BRACKET INJECTOR 39. BEARING JOURNAL / 2 40. IDLER GEAR / 2 41. BEARING CAP / 2 42. SCREW DOUBLE HEX M12 X 1.5 X 55 43. BEARING JOURNAL / 5 44. SCREW DOUBLE HEX M10 X 1.5 X 45 45. BEARING JOURNAL / 3 46. SCREW DOUBLE HEX M10 X 1.5 X 60 47. FLYWHEEL GASKET 48. FLYWHEEL COVER 49. PROFILE SEAL 50. CLOSER COVER 51. BOLT HEX HEAD FLANGE M8 X 30-10.9 52. HEX SCREW M14X1.5X 90-10.9 53. RADIAL SHAFT SEALING RING 54. SENSOR CRANKSHAFT SPEED 55. TIMING CASE COVER 56. BOLT HEX HEAD FLANGE 57. STUD 58. FLYWHEEL 59. SCREW DOUBLE HEX M12 X 1.5 X 83.5 60. BEARING CAP / 1 61. THRUST WASHER 62. BEARING JOURNAL / 1 63. BOLT HEX HEAD FLANGE M8 X 35 64. DOSER 65. BRACKET / MSU 66. ELASTOMER BEARING 67. COLLAR BUSHING 68. BUFFER FOR BREAKOUT 69. BOLT HEX HEAD FLANGE M8X1.25X40 70. BRACKET 71. COVER PROT V 21-WAY MCM CAP 72. MCM2.1-D3-HDEP-US-ROM-MY16 73. OIL SPRAY NOZZLE 74. THREADED COUPLINGS 75. SENSOR OIL PRESSURE MAX 1.6 MPA 76. SCREW MBN 10226-M6 X 16-8.8 77. HEXAGON NUT 78. TIMING PLATE 79. BOLT HEX HEAD FLANGE M10X 35 80. HIGH-PRESSURE TRANSFER PUMP 81. GEN II HPP BRACKET 82. SCREW MBN 10105 M12 X 1.5 X 25 83. BOLT HEX HEAD FLANGE M8X1.25X25 84. SEALING FLANGE-MY16 85. FUEL LINE 86. FUEL LINE 87. FUEL LINE 88. FUEL LINE 89. FITTING SCREW-IN DIN 7168 EN AW-6082 T6 90. AIR COMPRESSOR 91. O-RING 92. O-RINGS, TOROIDAL SEALING RINGS 93. NUT HEX W/ FLANGE M20X1.5 94. HXRD SCREW MBN 10143-M10X 30 95. BOLT HEX HEAD FLANGE M10X1.5X20 96. FITTED BEARING, UPPER HALF 97. CRANKSHAFT 98. FITTED BEARING LOWER HALF 99. O-RING / PRESSURE PIPE 100. OIL PUMP COMPL 101. O-RING / SUCTION PIPE 102. BRACKET 103. P-CLIP N 16016-B RSGU 15/15 104. HEX SCREW MBN 10105-M 6X 20 105. DIP STICK TUBE 106. HEXAGONAL HEAD SCREW WITH FLANGE 107. CLAMP HOSE 12-20 I.D. 108. BRACKET 109. OIL-PRESSURE LINE 110. OIL SUMP | <ol style="list-style-type: none"> 111. MAIN BEARING LOWER HALF 112. CONNECTING ROD 12.8 L 113. CONNECTING ROD BEARING LOWER HALF 114. CONNECTING ROD BEARING UPPER HALF 115. RETAINING RING / GUDGEON PIN 116. PISTON 117. MAIN BEARING, UPPER HALF 118. COOLANT LINE 119. BRACKET 120. WATER DRAIN HOSE 121. SINGLE-EYE CLAMP 122. TEMPERATURE SENSOR 123. THERMOSTAT 124. SEAL 125. GASKET SH.0 AND OTHER 126. STICKER / MOTOROEL 127. SEAL RING DIN 7603-A 33 X 39 128. PROTECTIVE COVER PRESS.SENSOR 129. FUEL FILTER COMPL / DDC 130. FUEL LINE 131. FUEL LINE 132. FUEL LINE 133. CONNECTION FITTING 134. STUD WITH METAL END 135. BRACKET 136. OIL SLINGER 137. ROTARY VIBRATION DAMPER MY16 138. DRIVING PLATE 139. HEXAGON HEAD BOLT M16 X 1.5 X 34 140. BOLT DIN 912 M10X40-10.9 | <ol style="list-style-type: none"> 141. GUIDE PULLEY 142. BRACKET / IDLER PULLEY 143. BOLT HEX HEAD FLANGE M10X1.5X60 144. BELT TENSIONER 145. RING SPACER 10 I.D. X 25 O.D. X 3.00 146. SEAL 147. CONNECTING PIPE 148. WASHER 20 O.D. X 14 I.D. X 1.5 149. BOLT HEX HEAD FLANGE M8X1.25X90 150. OUTLET NIPPLE / COOLANT 151. SEAL 152. SENSOR TEMPERATURE -40 TO 130 DEG C 153. EXHAUST GAS COOLER 154. BANJO UNION 155. EXHAUST COOLER 156. SCREW PLUG 157. WASHER 158. CRANKCASE / MIT LB AF-DDC 159. CYLINDER PIN |
|--|---|--|

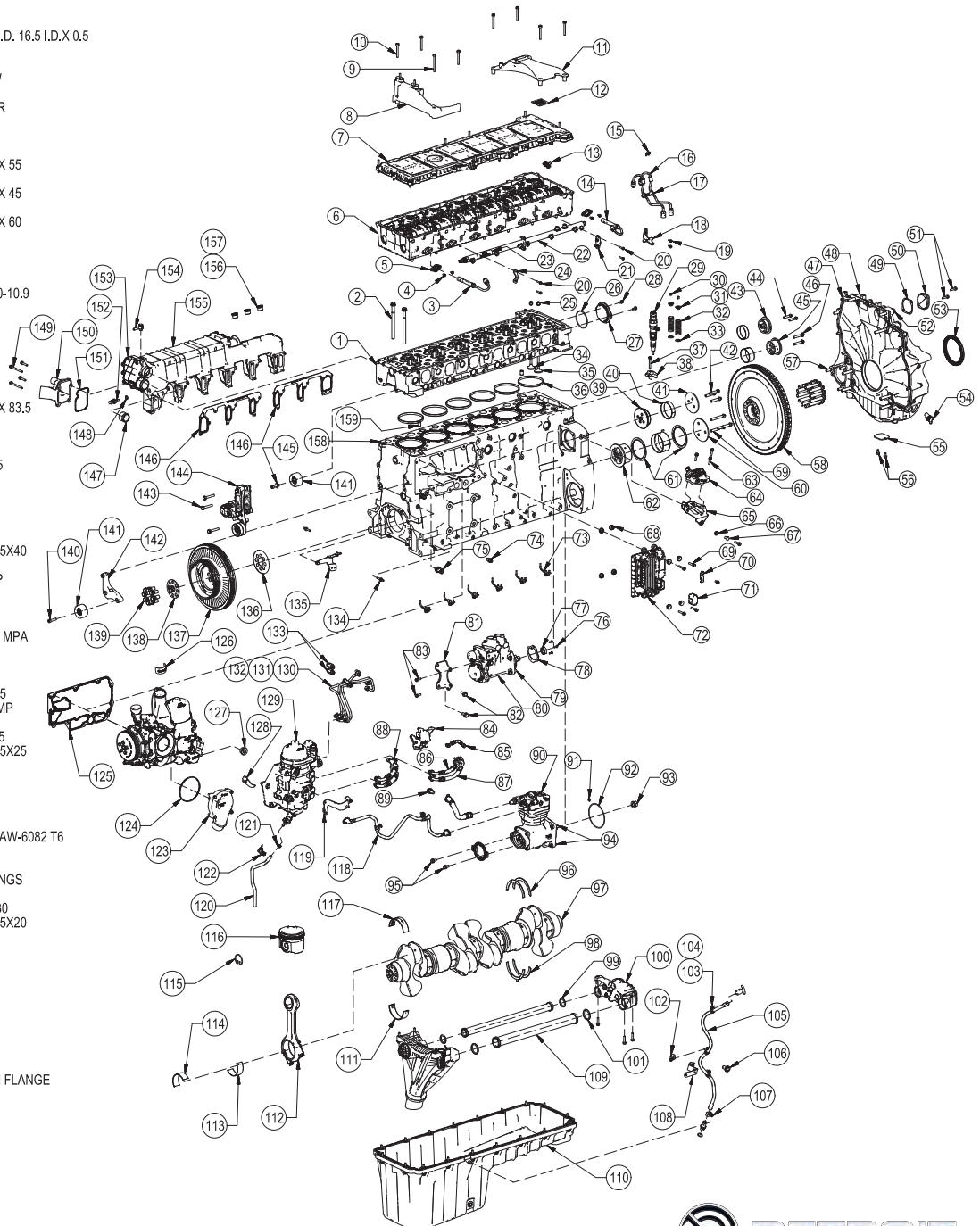

DD13 GHG17 (rear)

- 160. COOLANT LINE
- 161. EXHAUST GAS HOSE
- 162. CLAMP
- 163. EXHAUST GAS RECIRCULATION LINE
- 164. DIFF PRESSURE SENSOR
- 165. BOLT HEX HEAD FLANGE M6X1.0X25
- 166. BOLT HEX HEAD FLANGE M8X1.25X60
- 167. BEAM MY17
- 168. MOLDED HOSE
- 169. BEADED METAL SEAL
- 170. CRANKCASE COVER FRT
- 171. BOLT HEX HEAD FLANGE M10X1.5X30
- 172. RADIAL SHAFT SEALING RING
- 173. MAJOR ASSEMBLY CARRIER
- 174. BOLT HEX HEAD FLANGE M12X1.5X45
- 175. SCREW IN FITTING
- 176. PROTECTING RING
- 177. ELASTOMER-METAL SEAL
- 178. POSITION SENSOR / NOCKENWELLE
- 179. HXRD SCREW MBN 10226-M 6X 12
- 180. OIL SEPARATOR MY16
- 181. GASKET EXH MANIFOLD (FRONT)
- 182. EXHAUST MANIFOLD ENDS
- 183. HEXAGONAL HEAD SCREW WITH FLANGE
- 184. GUIDE SLEEVE
- 185. PIPE CLAMP FOR EXHAUST SYSTEM
- 186. HEAT SHIELD - CYL 1-2
- 187. BOLT HEX HEAD
- 188. HEAT SHIELD / AKMT-MY16
- 189. HEAT SHIELD / CYL 5-6
- 190. EXHAUST MANIFOLD MULTI-PIECE CENT.PART
- 191. GUIDE SLEEVE
- 192. PIPE CLAMP
- 193. EXHAUST GAS RECIRCULATION LINE (HOT PIPE)
- 194. EXHAUST PIPE
- 195. CLAMP
- 196. O-RING
- 197. INTAKE MANIFOLD CLEAN-AIR
- 198. CLAMP MBN 10223-130-150X13-SW8-W3
- 199. TEMPERATURE SENSOR
- 200. SCREENING PLATE MY16
- 201. EXHAUST-GAS TURBOCHARGER
- 202. SCREW HEX HEAD W/ FLANGE M8X16X12
- 203. BRACKET EXH.GAS-T-CHRGR
- 204. BRACKET / CABLE PLUG
- 205. BASE PLATE EXH.GAS-T-CHRGR
- 206. HEX SCREW MBN 10105-M8 X 50
- 207. INJECTION VALVE ASM/HC DIV3
- 208. EXHAUST GAS LINE
- 209. NUT PREVAILING TORQUE TYPE
- 210. FUEL LINE
- 211. FUEL LINE
- 212. FUEL LINE
- 213. HOLLOW SCREW N 15036
- 214. WASHER DIN 7603-A 10 X 16-CU CU/SN12
- 215. BRACKET
- 216. BOLT HEX HEAD FLANGE M8 X 20
- 217. CLAMP N 16016-B RSGU 6/ 20
- 218. SCREW-IN FITTING
- 219. GASKET, EXHAUST PIPE
- 220. OIL PRESSURE LINE EXH.GAS-T-CHRGR
- 221. SEALS FOR OVAL FLANGES
- 222. HEXAGONAL HEAD SCREW WITH FLANGE
- 223. METAL SEAL
- 224. COOLANT LINE-MY16
- 225. COOLANT LINE-MY16
- 226. FITTING - COOLANT RETURN
- 227. BOLT HEX HEAD FLANGE M8X1.25X80
- 228. SPACER BUSH MY16
- 229. SERVOMOTOR
- 230. LEVER / AGR-STELLER MY16
- 231. PULL ROD
- 232. HEXAGON NUT
- 233. BUSH WITHOUT CHAMFER MY16
- 234. EXHAUST MANIFOLD ENDS
- 235. GASKET EXH MANIFOLD (REAR)
- 236. BEARING COVER
- 237. SEAL - INTAKE MANIFOLD GASKET
- 238. CHARGE AIR HOUSING
- 239. SCREW COLLAR M8 48X13.3
- 240. WASHER 13 X 27 X 8
- 241. BOLT COLLAR M8 103.5X13.3
- 242. BRACKET CHARGE-AIR-PIPE / KALT
- 243. BOLT HEX HEAD FLANGE - M8 X 35
- 244. CHARGE AIR PIPE
- 245. HEX SCREW MBN 10105-M8 X 45
- 246. PROTECTIVE COVER / COMBI SENSOR
- 247. PRESSURE- AND TEMPERATURE SENSOR
- 248. EXHAUST GAS RECIRCULATION LINE
- 249. SUPPORT BRACKET EGR COLD PIPE
- 250. AIR INTAKE CONNECTOR
- 251. GASKET CHARGE-AIR-PIPE
- 252. TEMPERATURE SENSOR
- 253. INTAKE MANIFOLD HARNESS BRACKET
- 254. BOLT HEX HEAD FLANGE M8X1.25X12

