

# DD16 GHG17 (front)

1. CYLINDER HEAD/ W/O VALVES, SH.0 AND SF.
2. BOLT CYLINDER HEAD
3. HIGH-PRESSURE LINE
4. SCREW HEX MBN 10105-M6 X 25-12
5. SEALING FOR INJECTOR LINE
6. CAMSHAFT HOUSING COMPL - MY16
7. CYLINDER HEAD COVER
8. AIR FILTER SUPPORT BRACKET
9. BOLT HEX HEAD FLANGE M8 X 80
10. HEX SCREW MBN 10105-C M8 X 50
11. AIR FILTER SUPPORT BRACKET
12. WARNING SIGN-ENGINE LIFTING
13. SPEED SENSOR CAMSHAFT
14. SCREW DIN 912 - M 6 X 16
15. HIGH-PRESSURE LINE
16. HEXHDBOLT MBN 10105 - M6 X 12
17. BRACKET HIGH PRESSURE FUEL LINES DIAMETER 9-0.1
18. SCREW HEX MBN 10105 - M6 X 16
19. BRACKET
20. PRESSURE ACCUMULATOR
21. HIGH-PRESSURE LINE
22. TENSIONING BRACKET
23. TENSIONING BRACKET
24. SPHERICAL COLLAR BOLT
25. WARNING SIGN-HIGH PRES. FUEL
26. VALVE STEM SEAL
27. O-RING
28. CLOSING COVER
29. BOLT HEX HEAD FLANGE M8X1.25X16
30. LU INJECTOR C3.27 HDE
31. VALVE COLLAR
32. VALVE SPRING CAP
33. SPRING VALVE
34. WASHER VALVE SPRING CYLINDER HEAD 29.5X16.5X 0.5
35. BIHEXAGONAL BOLT
36. TENSIONING BRACKET INJECTOR
37. INTAKE VALVE
38. EXHAUST VALVE
39. CYLINDER PIN
40. CIRCULAR RING CYLINDER BUSH
41. BOLT HEX HEAD FLANGE MBN 10105 - M8 X 35
42. DOSER
43. BRACKET / MSU
44. ELASTOMER BEARING
45. COLLAR BUSHING (FOR MSU ISOLATION)
46. BUFFER FOR BREAKOUT
47. STG MCM/2.1 D4 MUSTER HDEP
48. BRACKET
49. BOLT HEX HEAD FLANGE M8X1.25X40
50. COVER PROT V 21-WAY MCM CAP
51. OIL SPRAY NOZZLE
52. HEX SCREW MBN 10105-M8 X 20
53. SENSOR OIL PRESSURE MAX 1.6 MPA
54. SENSOR TEMPERATURE -40 TO 130 DEG C
55. HEXAGON NUT
56. SCREW MBN 10226-M6 X 16
57. TIMING PLATE
58. DRIVE GEAR FUEL PUMP
59. BOLT HEX HEAD FLANGE MBN 10105-M10 X 35
60. HIGH-PRESSURE TRANSFER PUMP
61. SCREW MBN 10105 M12 X 1.5 X 25
62. GEN II HPP BRACKET
63. BOLT HEX HEAD FLANGE M8X1.25X25
64. FUEL LINE
65. SEALING FLANGE-MY16
66. FUEL LINE
67. FUEL LINE MY16
68. FUEL LINE
69. FITTING SCREW-IN DIN 7168 EN AW-6082 T6
70. COOLANT PIPING
71. AIR COMPRESSOR
72. O-RING
73. O-RINGS, TOROIDAL SEALING RINGS
74. NUT HEX W/ FLANGE M20X1.5
75. HXR D SCREW MBN 10143-M10X 30
76. LOCK COVER
77. BOLT HEX HEAD FLANGE M10X1.5X20
78. FITTED BEARING, UPPER HALF
79. CRANKSHAFT
80. FITTED BEARING, LOWER HALF
81. O-RING / PRESSURE PIPE
82. OIL PUMP COMPL
83. O-RING / SUCTION PIPE
84. BRACKET
85. BOLT HEX HEAD FLANGE MBN 10105-M 8X 20
86. DIPSTICK
87. HEX SCREW MBN 10105 - M6 X 20
88. HEXAGONAL HEAD BOLT
89. P-CLIP N 16016-B RSGU 15 / 15
90. DIPSTICK TUBE
91. CLAMP HOSE 12-20 I.D MBN 16026
92. BRACKET
93. OIL SUMP
94. OIL SUCTION MANIFOLD
95. MAIN BEARING LOWER HALF
96. CONNECTING ROD OVAL BORE
97. CONNECTING ROD BEARING LOWER HALF
98. CONNECTING ROD BEARING UPPER HALF
99. RETAINING RING / GUDGEON PIN
100. PISTON
101. MAIN BEARING UPPER HALF
102. CLAMP N 16016-BRSU 15/20
103. COOLANT LINE
104. BRACKET
105. SINGLE EYE CLAMP
106. WATER DRAIN HOSE
107. FUEL FILTER COMPL
108. PROTECTIVE COVER PRESS.SENSOR
109. BOLT HEX HEAD FLANGE M6X1.0X12
110. BOLT HEX HEAD FLANGE M10X1.5X55

111. THERMOSTAT
112. BOLT HEX HEAD FLANGE M8X1.25X50
113. SEAL
114. OIL-COOLANT MODULE / SWP-MY16
115. GASKET SH.0 AND OTHER
116. SEAL RING DIN 7603-A 33 X 39-CU CU/SN12
117. CONNECTION FITTING
118. FUEL LINE
119. FUEL LINE
120. FUEL LINE
121. STUD WITH METAL END
122. BRACKET HARNESS 10 PIN CONNECTOR
123. BOLT HEX HEAD FLANGE M8X1.25X12
124. BOLT HEX HEAD FLANGE M10X1.5X30
125. OIL SLINGER
126. ROTARY VIBRATION DAMPER
127. DRIVING PLATE
128. GUIDE PULLEY
129. BOLT DIN 912 M10X40
130. BOLT HEX HEAD FLANGE M10X1.5X40
131. BRACKET / IDLER PULLEY
132. HEXAGON HEAD BOLT M16 X 1.5 X 34
133. BELT TENSIONER
134. CRANKCASE COVER FRT
135. RADIAL SHAFT SEALING RING
136. BEADED METAL SEAL
137. RING SPACER 10 I.D. X 25 O.D. X 3.00
138. SEAL
139. COLLECTOR-MY16
140. CONNECTING PIPE
141. SEAL
142. OUTLET NIPPLE / COOLANT
143. BOLT HEX HEAD FLANGE MBN 10105-C M 8X 100
144. BEAM
145. RETAINING STRAP
146. BANJO UNION
147. HOLLOW SCREW N 15036-A10 DBL8451.16
148. EXHAUST GAS RECIRCULATION COOLER
149. SCREW PLUG
150. SCREW PLUG DIN 908-M16X1.5-ST
151. SEAL RING DIN 7603-A 16 X 22-CU CU/SN12
152. CYLINDER CRANKCASE / MIT LINERS EPA 13
153. CYLINDER HEAD GASKET

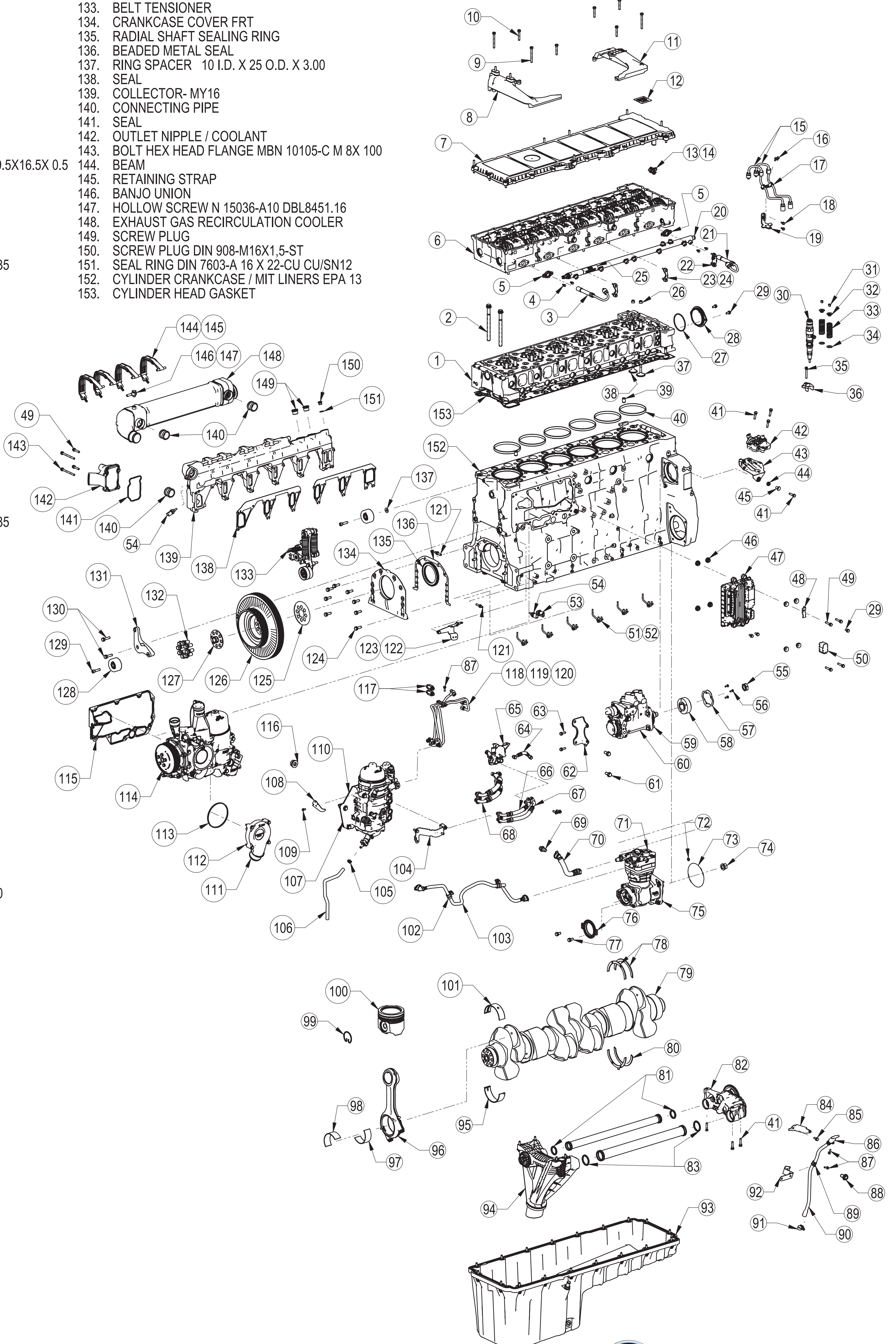

# DD16 GHG17 (rear)

- 154. COOLANT LINE
- 155. EXHAUST GAS HOSE
- 156. CLAMP
- 157. EXHAUST GAS RECIRCULATION LINE / VENTURI MY16
- 158. BOLT HEX HEAD FLANGE M8X1.25X60
- 159. DIFF PRESSURE SENSOR
- 160. BOLT HEX HEAD FLANGE M6X1.0X25
- 161. BEAM MY17
- 162. MOLDED HOSE
- 163. MAJOR ASSEMBLY CARRIER
- 164. BOLT HEX HEAD FLANGE M12X1.5X45
- 165. SCREW IN FITTING
- 166. PROTECTING RING
- 167. POSITION SENSOR / NOCKENWELLE
- 168. HXRD SCREW MBN 10226 - M6 X 12
- 169. OIL SEPARATOR MY16
- 170. ELASTOMER-METAL SEAL
- 171. REDUCTION GEAR
- 172. SEAL EXHAUST MANIFOLD GASKET 3 PORT
- 173. EXHAUST MANIFOLD
- 174. HEXAGONAL HEAD SCREW WITH FLANGE
- 175. GUIDE SLEEVE
- 176. PIPE CLAMP FOR EXHAUST SYSTEM MY16
- 177. HEAT SHIELD
- 178. BOLT HEX HEAD DBL 4550.00 L12
- 179. HEXAGON NUT
- 180. TOWBAR
- 181. WASHER 20 O.D. X 14 I.D. X 1.5
- 182. COUPLNG N 15023-A 10-ST
- 183. COOLANT LINE
- 184. SERVOMOTOR
- 185. STUD BOLT
- 186. BOLT HEX HEAD W/ WASHER
- 187. LEVER / AGR-STELLER
- 188. FITTING - COOLANT RETURN
- 189. BRACKET / EGR-ACTUATOR HARNESS
- 190. BRACKET
- 191. HEAT SHIELD EGR ACTUATOR
- 192. HEX HEAD BOLT MBN 10105-M 8X 35-1.7711-CU8MT
- 193. OIL PRESSURE LINE / TURBOCOMPOUND-MY16
- 194. INTAKE MANIFOLD CLEAN-AIR
- 195. HXRD SCREW MBN 10226-M 6X 12- 8.8
- 196. TEMPERATURE SENSOR / INTAKE AIR WITH FLANGE
- 197. CLAMP MBN 10223-130-150X13-SW8-W3
- 198. METAL SEAL-MY16
- 199. OIL PRESSURE LINE EXH.GAS-T-CHRG
- 200. THERMAL SCREEN / TURBOCHARGER
- 201. HEX SCREW MBN 10105-M 8X 20
- 202. SEALS FOR OVAL FLANGES
- 203. OIL RETURN LINE
- 204. BRACKET A1011 STEEL W E-COAT
- 205. COMPRESSED AIR LINE
- 206. PIPE CLAMP
- 207. EXHAUST GAS LINE
- 208. PIPE CLAMP
- 209. BOLT HEX HEAD FLANGE M10X1.5X50
- 210. BOLT HEX HEAD FLANGE M10X1.5X30
- 211. BRACKET
- 212. WASTE-GAS TURBINE MY16
- 213. GASKET METAL
- 214. OIL RETURN PIPE
- 215. BOLT HEX FLANGE HEAD M6X1.0X16
- 216. DICHTRING 20X6 / SEALING RING 20X6
- 217. BOLT HEX HEAD FLANGE M10X1.5X90
- 218. HEX SCREW MBN 10105-M10X 65
- 219. METAL SEAL
- 220. STUD
- 221. EXHAUST GAS RECIR. VALVE
- 222. HEXAGON NUT WITH FLANGE
- 223. PIPE CLAMP
- 224. EXHAUST GAS RECIRCULATION LINE (HOT PIPE)
- 225. METAL SEAL / S-PIPE
- 226. BOLT HEX HEAD FLANGE M10X1.5X45-10.9
- 227. BOLT HEX HEAD FLANGE M6X1.0X10-10.9
- 228. HEX SCREW MBN 10105-M 8X 50- 10.9 DBL9400.40
- 229. WASHER DIN 7603-A 10 X 16-CU CU/SN12
- 230. SCREW-IN FITTING
- 231. BOLT HEX HEAD FLANGE M8X1.25X16-10.9
- 232. COOLANT LINE MY16
- 233. HEAT SHIELD
- 234. HC DOSER SPRAY SHIELD BRACKET
- 235. BRACKET
- 236. FUEL LINE MY16
- 237. SPINDLE IDLER 4
- 238. THRUST WASHER
- 239. IDLER GEAR / 4
- 240. BEARING CAP / 4
- 241. BEARING JOURNAL / 1
- 242. RADIAL SHAFT SEALING RING
- 243. FLYWHEEL HOUSING
- 244. TIMING CASE COVER
- 245. FLYWHEEL
- 246. PROFILE SEAL
- 247. CLOSING COVER
- 248. BOLT HEX HEAD FLANGE MBN 10105-M 8X 30
- 249. SCREW DOUBLE HEX M10 X 1.5 X 60 DIN 7167
- 250. EXHAUST GAS RECIRCULATION LINE-MY16
- 251. PROTECTIVE COVER / COMBI SENSOR
- 252. PRESSURE- AND TEMPERATURE SENSOR
- 253. THROTTLE VALVE
- 254. SEAL / LADELUFTROHR
- 255. AIR INTAKE
- 256. BRACKET / AGR-LEITUNG
- 257. BOLT HEX HEAD FLANGE MBN 10105-C M 8X 100
- 258. BOLT HEX HEAD FLANGE MBN 10105-M10X 35
- 259. WASHER 13 X 27 X 8 DIN 7715
- 260. SPACER TUBE
- 261. DD15/16 COLD-AIR BOOST PIPE BRACKET
- 262. GASKET CHARGE-AIR-PIPE
- 263. SCREW COLLAR M8 48X13.3 ISO 2768-M DIN 26729
- 264. INTAKE MANIFOLD HARNESS BRACKET
- 265. TEMPERATURE SENSOR-MY16
- 266. CHARGE AIR MANIFOLD MY16
- 267. SEAL - INTAKE MANIFOLD GASKET
- 268. CHARGE AIR PIPE
- 269. CLIP IATV CONNECTOR S60
- 270. SENSOR CRANKSHAFT SPEED 40-7000 RPM

