

DD8 GHG17 (front)

- 1.CYLINDER HEAD/WITH ROCKER ARM FRAME
- 2.HEX SCREW MBN10105-M8X65-10.9DBL9440.40
- 3.BOLT
- 4.REAR SUSPENSION EYE
- 5.HEX SCREW MBN10105-M14X1,5X30-10.9DBL9440.40
- 6.CYLINDER HEAD COVER
- 7.VALVE COLLET
- 8.VALVE SPRING PLATE
- 9.VALVE SPRING OUTLET
- 10.VALVE STEM SEAL
- 11.THRUST PLATE
- 12.O RING
- 13.CLOSING COVER
- 14.BOLT HEX HEAD FLANGE M8X1.25X16-10.9
- 15.PRESSURE SENSOR-CRANKCASE
- 16.IDLER GEAR/Z12
- 17.BEARING JOURNAL/Z12
- 18.BOLT HEX HEAD FLANGE MBN10105-M10X35-10.9DBL9440.40
- 19.SUSPENSION EYE RR
- 20.INJECTOR
- 21.CLAMPING BRACKET
- 22.SPHERICAL COLLAR BOLT
- 23.HIGH PRESSURE LINE
- 24.COMMON RAIL
- 25.HXRD SCREW MBN10143-M10X80-10.9DBL9440.40
- 26.BOLT HEX HEAD FLANGE MBN10105-CM8X100-10.9DBL9440.40
- 27.BEARING BRACKET OUTLET
- 28.ROCKER SHAFT OUTLET COMPL W EXHAUST-BRAKE
- 29.BEARING BRACKET OUTLET
- 30.BEARING BRACKET INLET
- 31.ROCKER SHAFT INLET COMPL
- 32.CAM SHAFT ADJUSTER
- 33.CENTRAL VALVE
- 34.CAMSHAFT BEARING UPR
- 35.CAMSHAFT OUTLET W BRAKE
- 36.CAMSHAFT INLET
- 37.CAMSHAFT BEARING LWR
- 38.CYLINDER HEAD GASKET
- 39.IDLER GEAR/Z11
- 40.BEARING JOURNAL/Z11
- 41.BOLT HEX HEAD FLANGE M10X1.5X50-10.9
- 42.IDLER GEAR/Z2Z7O.NA
- 43.BEARING JOURNAL/Z2/Z7WITHOUT POWER TAKEOFF
- 44.HEX SCREW MBN10105-M10X65-10.9DBL9440.40
- 45.IDLER GEAR/Z8Z10
- 46.BEARING JOURNAL/Z8/Z10
- 47.HEX SCREW MBN10105-M12X1.5X60-10.9DBL9440.40
- 48.CRANKCASE
- 49.IDLER GEAR F AIR COMPRESSOR/Z5
- 50.BEARING JOURNAL/Z5

- 51.DRIVE GEAR F AIR COMPRESSOR
- 52.NUT HEXW/FLANGEM20X1.5
- 53.CABLE FIXING CLIP
- 54.COVER
- 55.PLUG
- 56.FLYWHEEL HOUSING/SAE2M.M-FLANSCH
- 57.BOLT HEX HEAD FLANGEM10X1.5X90-10.9
- 58.BOLT HEX HEAD FLANGEM10X1.5X110-10.9
- 59.O RING
- 60.HEXAGON NUT MBN10112M8-8
- 61.CLOSING COVER
- 62.BOLT HEX HEAD FLANGEM8X1.25X25-10.9
- 63.FLYWHEEL COMPL/SAE2
- 64.BALL BEARING
- 65.CAP SCREW
- 66.SENSOR CRANKSHAFT SPEED 40-7000RPM
- 67.BOLT HEX HEAD FLANGEM10X1.5X55-10.9
- 68.SHAFT LIP TYPE SEAL
- 69.BRACKET
- 70.BOLT HEX HEAD FLANGE MBN10105-M8X20-10.9
- 71.NOISE DAMPER
- 72.SUCTION LINE
- 73.AIR COMPRESSOR
- 74.O-RINGS, TOROIDAL SEALING RINGS
- 75.SCREW MBN10143-M10X40X10.9DBL9440.40
- 76.STUD
- 77.HIGH-PRESSURE TRANSFER PUMP FOR COMMONRAIL
- 78.BOLT HEX HEAD FLANGE M10X1.5X40-10.9
- 79.HIGH-PRESSURE LINE,PAGEOFF.
- 80.BOLT HEX HEAD FLANGE M8X1.25X40-10.9
- 81.STANCHION /HIGH PRESSURE PUMP
- 82.BOLT HEX HEAD FLANGE MBN10105-M8X30-10.9
- 83.FUEL LINE
- 84.FUEL LINE
- 85.FUEL LINE
- 86.FUEL LINE
- 87.FITTING SCREW-INDIN7168ENAW-6082T6
- 88.COOLANT LINE
- 89.COOLANT LINE
- 90.CRANKSHAFT GEAR/Z1

- 91.FUEL FILTER
- 92.PRESSURE SENSOR / FUEL FILTER
- 93.BRACKET
- 94.SENSOR TEMPERATURE-40TO130DEGCDIN40050IP67, IP69K
- 95.HEX SCREW MBN10105-CM8X70-10.9DBL9440.40
- 96.WATER HOSE
- 97.CTRL UNIT MCM/2.1D4MUSTERMDEGNAFTAROMW/OC
- 98.COVER PROTV21-WAYMCMCAP
- 99.OIL DIPSTICK
- 100.OIL DIPSTICK TUBE
- 101.P-CLIP N16016-BRSGU15/15
- 102.BRACKET
- 103.SCREW HEX MBN10105-M6X16-10.9DBL9440.40
- 104.BRACKET
- 105.OIL SUMP
- 106.MAIN BEARING,UPPERHALF
- 107.CRANKSHAFT
- 108.MAIN BEARING LOWER HALF
- 109.CONNECTING ROD BEARING UPPER HALF
- 110.CONNECTING ROD BEARING LOWER HALF
- 111.CONNECTING ROD
- 112.PISTON
- 113.OIL SPRAY NOZZLE
- 114.SLEEVE SOCKET
- 115.COVER PLATE FRONT
- 116.RADIAL SEAL
- 117.ROTARY VIBRATION DAMPER
- 118.BOLT
- 119.ENGINE MOUNT FRT
- 120.BOLT HEXHEAD FLANGEM16X1.5X90-10.9
- 121.HEX SCREW MBN10105-M16X1,5X50-10.9DBL9440.40
- 122.GUIDE PULLEY
- 123.BOLT
- 124.GUIDE PULLEY
- 125.HXRD SCREW MBN10142-M10X30-10.9
- 126.BELT TENSIONER
- 127.COOLANT LINE
- 128.PRESSURE AND TEMPERATURE SENSOR
- 129.HXRD SCREW MBN10226-M6X25-8.8DBL9440.40
- 130.INTERMEDIATE FLANGE

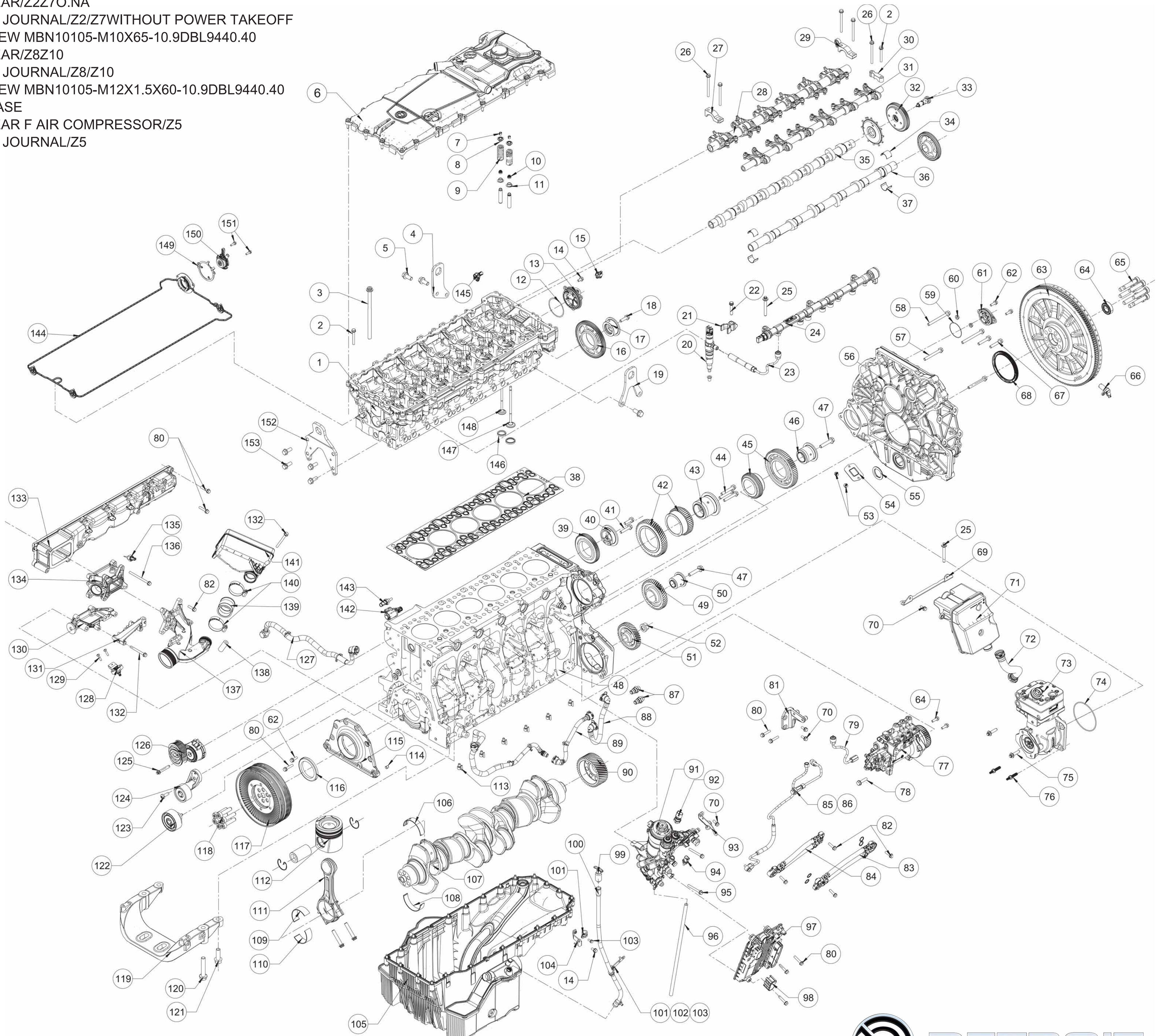

DD8 GHG17 (rear)

- 131.STANCHION CHARGE-AIR-PIPE
- 132.BOLT HEXHEAD FLANGE M8X1.25X80-10.9
- 133.CHARGE AIR HOUSING
- 134.MIXING CHAMBER
- 135.TEMPERATURE SENSOR
- 136.HEX SCREW MBN10105-CM8X110-10.9DBL9440.40
- 137.CHARGE AIR PIPE/COLD
- 138.SPACER BUSH
- 139.MOLDED HOSE
- 140.CLAMP MBN10272-A-40-60X13-SW8-W3
- 141.RESONANC EBOX
- 142.SOLENOID VALVE
- 143.SENSOR TEMPERATURE
- 144.CIRCUMFERENTIAL GASKET
- 145.SPEED SENSOR CAMSHAFT
- 146.VALVE SEAT RING
- 147.INTAKE VALVE
- 148.ZB EXHAUST VALVE
- 149.SPRING STEEL SHEET /PHASENSTELLER
- 150.SOLENOID
- 151.HEX SCREW MBN10105-M6X20-10.9DBL9440.40
- 152.SUSPENSION EYE
- 153.HEX SCREW MBN 10105-M12X1,5X 30- 10.9 DBL9440.40
- 154.SUCTION LINE
- 155.EXHAUST GAS RECIRCULATION LINE/COLD
- 156.EGR VALVE
- 157.CONNECTION FITTING
- 158.BOLT HEX HEAD FLANGE M8X1.25X60-10.9
- 159.HOLDER
- 160.BOLT HEX HEAD FLANGE MBN 10105-M12X1,5X 40- 10.9
- 161.HXRD SCREW MBN10143-M10X70-10.9DBL9440.40
- 162.BRACKET EXH.GAS-COOLER UPR
- 163.VENT LINE
- 164.SCREENING PLATE /AGR
- 165.RETAINING STRAP
- 166.EXHAUST GAS COOLER
- 167.BOLT HEX HEAD FLANGE M8X1.25X50-10.9
- 168.CONNECTION HOUSING
- 169.METAL SEAL
- 170.SEAL

- 171.HEX SCREW MBN10105-CM8X130-10.9
- 172.HOLDER EXHAUST COOLER
- 173.GASKET
- 174.EXHAUST MANIFOLD END-PIECE COMPL
- 175.PIPE CLAMP
- 176.EXHAUST GAS RECIRCULATION LINE /HOT
- 177.CLAMPING BRACKET
- 178.HEX HEAD SCREW W FLANGE
- 179.HEX HEAD SCREW W FLANGE
- 180.EXHAUST MANIFOLD CENT.PART
- 181.EXHAUST MANIFOLD END-PIECE COMPL
- 182.VENT LINE
- 183.PRESSURE SENSOR
- 184.CLAMP MBN10371-28,5X10X0,8-10,0
- 185.VENT LINE OIL SUMP FRIGO
- 186.BRACKET VENT-LINE
- 187.CAP WITH FITTING FOR DOUBLE THERMOSTAT
- 188.THERMOSTAT COOLANT
- 189.OIL-COOLANT MODULE
- 190.HEX SCREW MBN10105-CM8X220-10.9
- 191.BOLT HEX HEAD FLANGE M8X1.25X90-10.9
- 192.OIL PRESSURE SWITCH
- 193.SENSOR TEMPERATURE
- 194.COOLANT OUTLET CONNECTION
- 195.BOLT HEXHEAD FLANGE MBN10105-M8X35-10.9
- 196.HOLDER CHARGE TUBE / HOT
- 197.CHARGE AIR PIPE /HOT/SINGLE STAGE
- 198.CLAMP
- 199.EXHAUST-GAS TURBOCHARGER
- 200.COOLANT LINE
- 201.AIR INTAKE
- 202.PIPE HOSE
- 203.SPEED SENSOR ATL
- 204.OIL RETURN LINE
- 205.HXRD SCREW MBN10142-M8X20-SD
- 206.SCREENING PLATE EXH.GAS-T-CHRGR/2-STUFIG
- 207.HEX SCREW MBN10105-M8X16-10.9
- 208.HOLDER ATL
- 209.HEX BOLT
- 210.PIPE CLAMP

- 211.COOLANT LINE
- 212.COOLANT LINE
- 213.HEAT SHIELD
- 214.BRACKET /LAMBDA SENSOR CABLE
- 215.LAMBDA PROBE
- 216.FLANGED MANIFOLD
- 217.BRACKET /FLANGE ELBOW
- 218.HEX SCREW MBN10105-M8X25-10.9DBL9400.40
- 219.WASHER RALLELFACES
- 220.HEXAGONAL HEAD SCREW WITH FLANGE
- 221.INJECTION VALVE ASM/HCDIV3
- 222.CLAMP N16016-BRS6/15
- 223.HEX HEAD BOLT MBN10105-M6X12-10.9DBL9400.40
- 224.SCREENIN GPLATE
- 225.FUEL LINE
- 226.HEAT SHIELD
- 227.HXRD SCREW MBN10228-M6X12-8.8DBL8451.72
- 228.CAP BOLT ISO4762-M8X50-10.9DBL9400.00
- 229.BRACKET
- 230.BOLT HEX HEAD FLANGE M10X1.5X30-10.9
- 231.OIL PRESSURE LINE
- 232.CLAMP N16016-BRS6/20
- 233.TIMING CASE
- 234.BOLT HEX HEAD FLANGEM10X1.5X25-10.9
- 235.OIL PUMP
- 236.HEX SCREW MBN10105-M8X45-10.9DBL9440.40
- 237.BRACKET
- 238.ZB METERIN GUNIT
- 239.BOLT HEX HEAD FLANGE MBN10105-M8X35-10.9
- 240.FUEL LINE
- 241.FUEL LINE
- 242.HEAD CAP SCREW

